

LONGBRIDGE LANE/COOMBES LANE TURVES GREEN JUNCTION PROPOSED GENERAL ARRANGEMENT CA_02712_S1_034

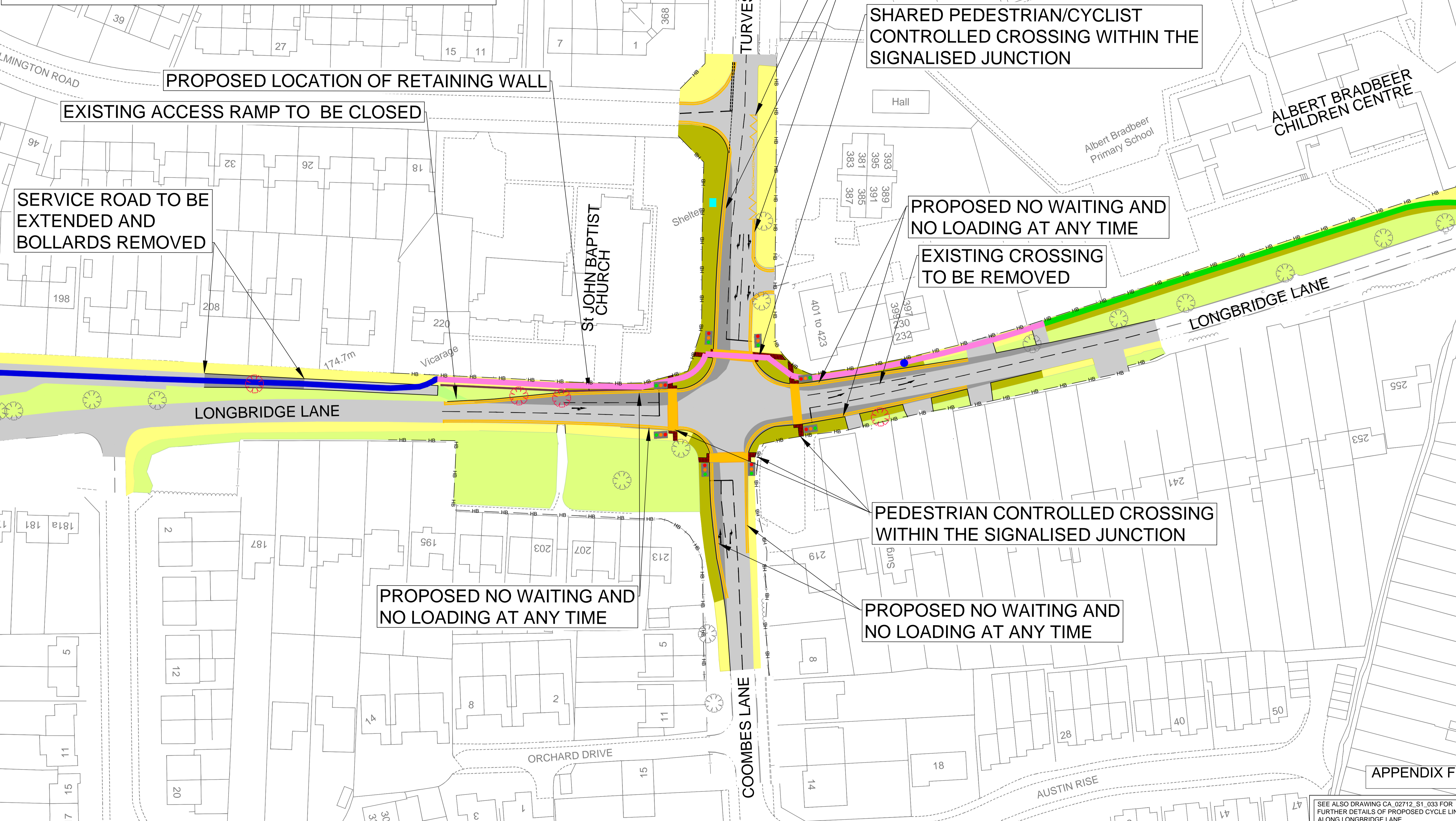

KEY		Existing landscaping		Existing bus stop to be upgraded by centro		Proposed segregated cycle route on footway		Proposed bus stop to be installed by Centro	
	Proposed landscaping		Existing landscaping		Existing bus stop to be upgraded by centro		Proposed segregated cycle route on footway		Proposed bus stop to be installed by Centro
	Proposed footway		Existing tree to remain		Proposed traffic signals		Proposed cycle route on carriageway		Highway Boundary
	Proposed Carriageway		Existing tree to be removed; replacement trees will be provided		Proposed un-segregated cycle route on footway		Proposed double yellow lines No waiting no loading restriction		Proposed kerb
	Existing Footway								
	Proposed pedestrian crossing								
	Existing Carriageway								

APPENDIX F

SEE ALSO DRAWING CA_02712_S1_033 FOR FURTHER DETAILS OF PROPOSED CYCLE LINK ALONG LONGBRIDGE LANE

<p>Birmingham City Council ANNE SHAW HEAD OF TRANSPORTATION SERVICES 1 LANCASTER CIRCUS BIRMINGHAM B4 7DQ</p>	<p>SCHEME: LONGBRIDGE CONNECTIVITY LONGBRIDGE LANE/TURVES GREEN/COOMBES LANE JUNCTION</p>		DATE	REV	REVISIONS	DRN	PM
	<p>DRAWING: PROPOSED GENERAL ARRANGEMENT</p>		DATE	REV	REVISIONS	DRN	PM
<p>BSI ISO 9001 Quality Management</p>	<p>ICE award winner K3 West Midlands Annual Awards</p>	<p>DRAWING STATUS: GENERAL</p>		SCALE: 1:500			
<p>DWG No: CA_02712_S1_034</p>							

FILE PATH: C:\TEMP\Project\Traffic - BCC Longbridge Lane Junctions\CA_02712_S1_034\034.dwg