

MAP REFERRED TO IN THE BIRMINGHAM CITY COUNCIL (POOLWAY SHOPPING CENTRE MEADWAY) COMPULSORY PURCHASE ORDER 2016

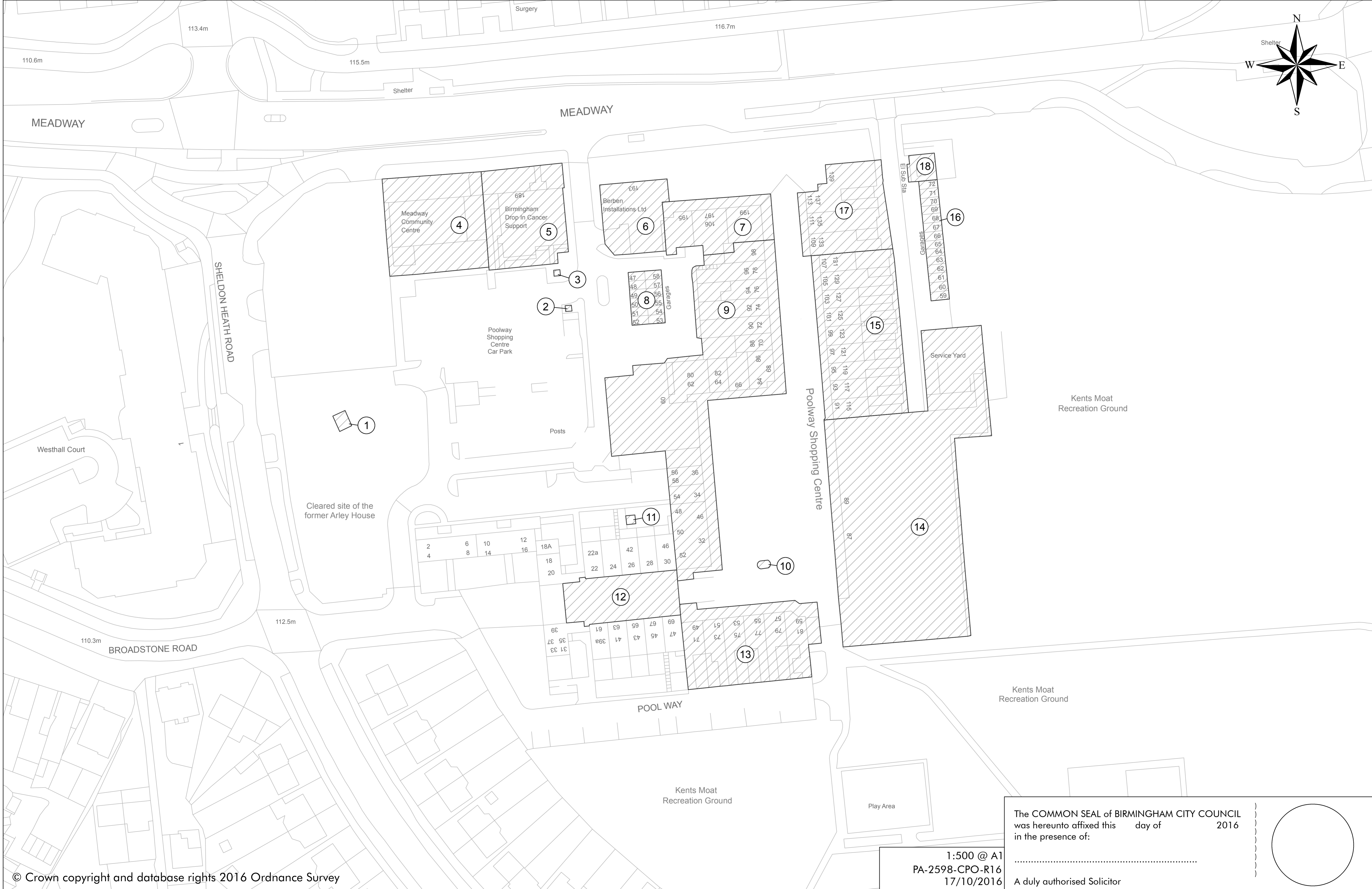

The COMMON SEAL of BIRMINGHAM CITY COUNCIL
was hereunto affixed this day of 2016
in the presence of:

.....

A duly authorised Solicitor

