

I, Robin Stuart Berry, for and on behalf of THE SECRETARY OF STATE FOR DEFENCE, and acting under the authority conferred upon me by the said Secretary of State DO SOLEMNLY AND SINCERELY DECLARE as follows:

1. The Secretary of State for Defence on the 7th day of September 2005 in accordance with Section 31(6) of the Highways Act 1980 caused to be deposited with the Birmingham City Council a map of Sutton Coldfield an Establishment vested in the said Secretary of State within the area administered by such Council together with a statement indicating what ways (if any) over that land the said Secretary of State admitted to have been dedicated as highways.

2. No additional way over the land delineated on the map so deposited with the Birmingham City Council has been dedicated as a highway.  
AND I MAKE this solemn declaration conscientiously believing the same to be true and by virtue of the provisions of the Statutory Declarations Act 1835

DECLARED at  
(address)

THE OLD PICTURE HOUSE, HIGH STREET,  
BISHOP'S CASTLE, SHROPSHIRE SY9 5BQ

.....  
.....  
.....  
this 15th day of December 2007  
Before me,

(signature)

(print name)

A Practicing Solicitor or Commissioner for Oaths

(signature of Declarant)

for and on behalf of THE SECRETARY OF STATE FOR DEFENCE

(print name)

(position within Defence Estates)

R. S. BERRY

Head CMS Shrewsbury

SUTTON COLDFIELD : D.E.O. H.Q.

Birmingham

Scale 1/2500 SP 1396

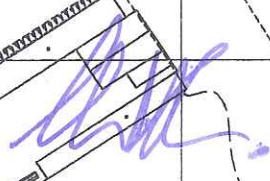
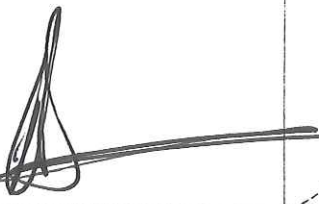
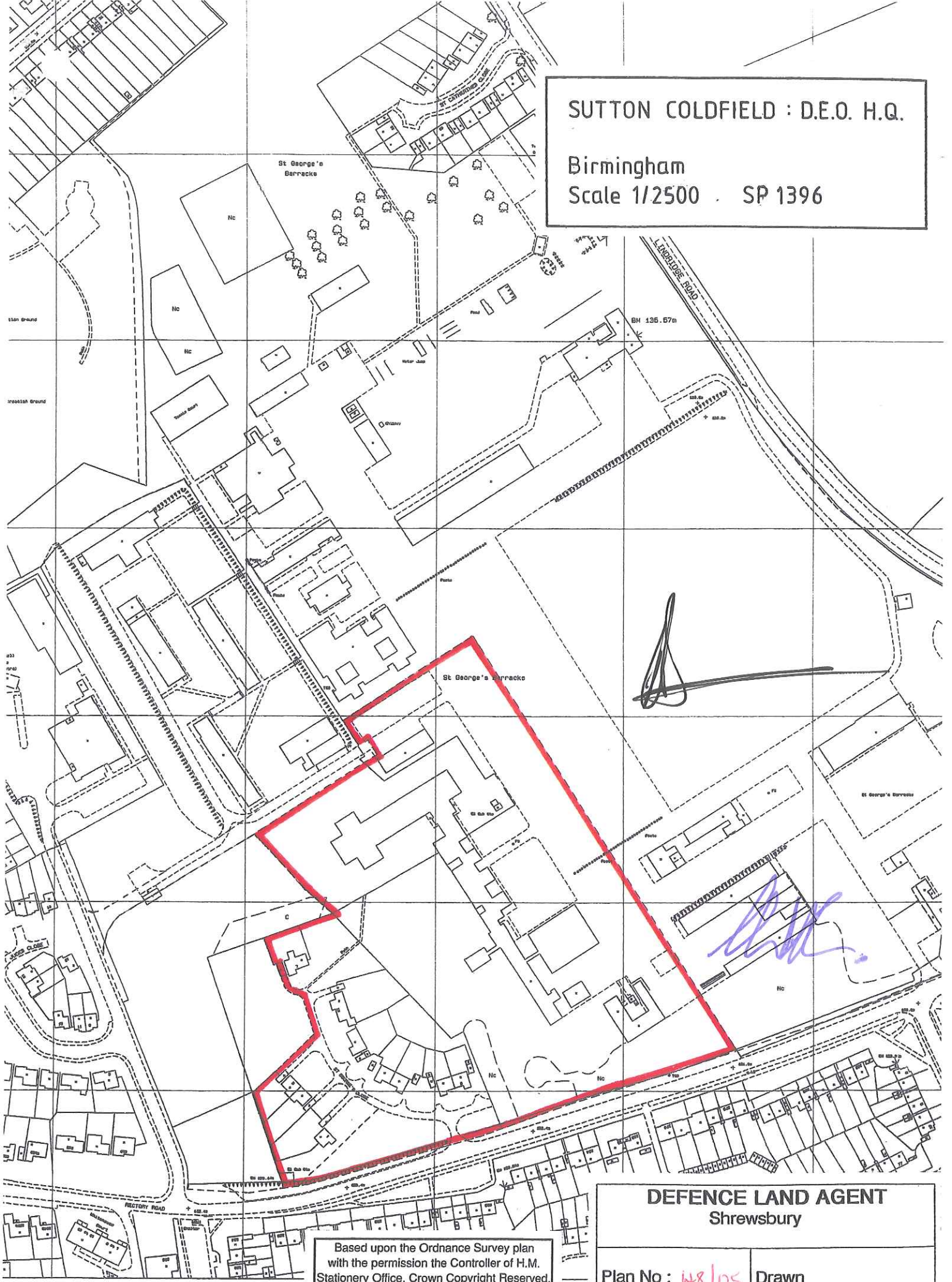

**DEFENCE LAND AGENT**  
Shrewsbury

Based upon the Ordnance Survey plan  
with the permission the Controller of H.M.  
Stationery Office. Crown Copyright Reserved.

Plan No : 48/05

Drawn  
Date

GD272353