

1807-06 - BCC Clean Air Zone Services\B2309014 CAZ Early Measures Bus Schemes\06 Drawings\04 Hockley Hill\0000 General Arrangement\B2309014-JAC-HGN-04_03-DR-CH-1001 R01.dwg - 23/01/2020 09:15:10 - Sheet02 - greenbcb

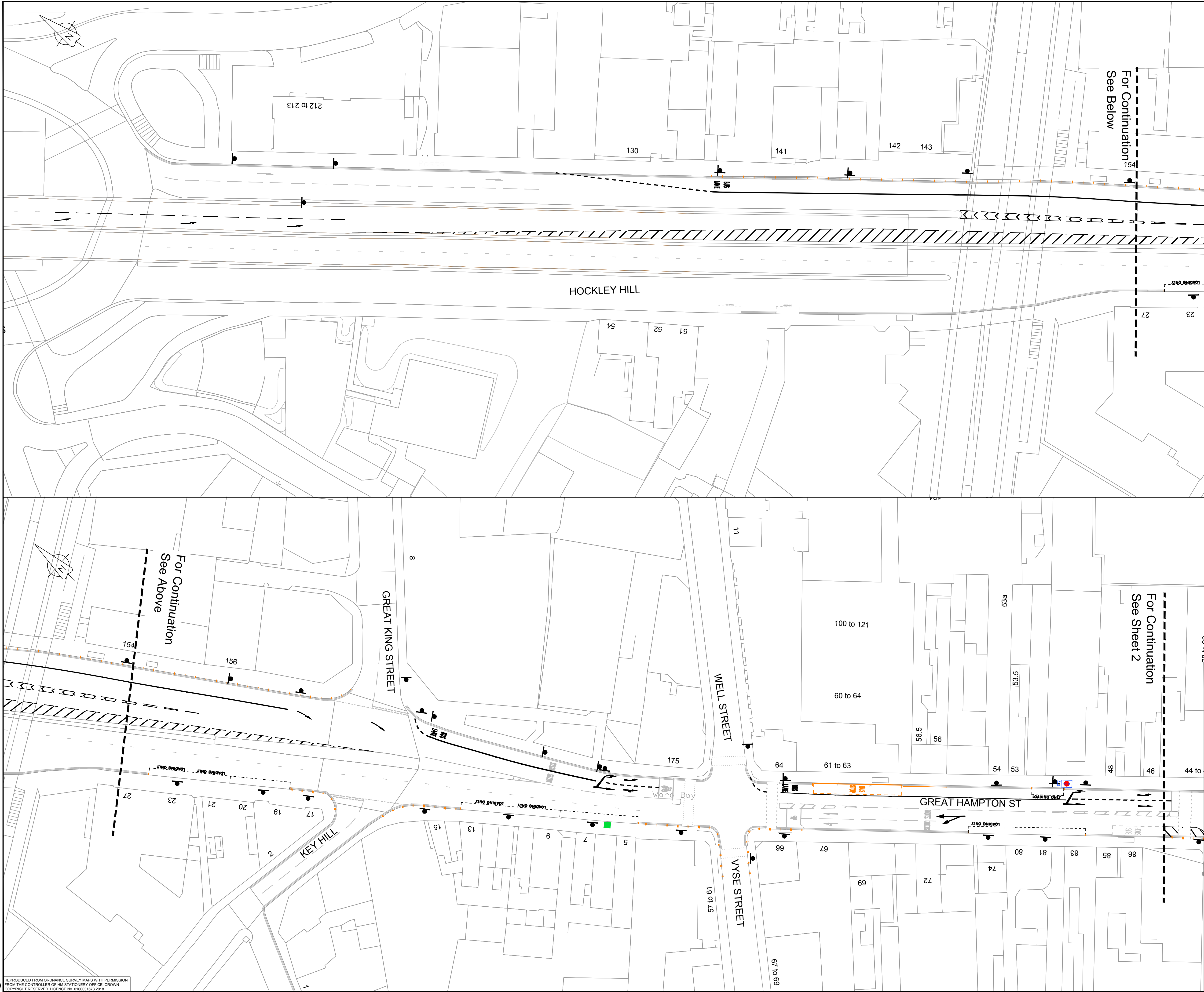

- Notes:
- 1) Drawing to be printed in colour.
 - 2) Do not scale from this drawing.
 - 3) This drawing to be read in conjunction with other relevant drawings.
 - 4) All dimensions in metres unless otherwise noted.
 - 5) For details of road markings refer to drawings B2309014-JAC-HMK-04_03-DR-CH-1001 to B2309014-JAC-HMK-04_03-DR-CH-1003.
 - 6) For details of signs refer to drawings B2309014-JAC-HSN-04_03-DR-CH-1001 to B2309014-JAC-HSN-04_03-DR-CH-1005.
 - 7) For details of signals refer to drawings B2309014-JAC-HGN-04_03-DR-EC-1001 to B2309014-JAC-HGN-04_03-DR-EC-1003.
 - 8) For details of pavement clearance and proposed works refer to drawing B2309014-JAC-HPV-04_03-DR-CH-1001.
 - 9) All Pay & Display machines to be solar powered, as per Parkeon's Strada Evolution 2.

- Key:
- Proposed road markings
 - Proposed signs
 - Proposed Pay & Display machines
 - Potential location for ANPR camera
 - Proposed kerb
 - Proposed tactiles

Rev	Rev. Date	Comments	Drawn	Checked	Rev'd	App'n'd
R01	22/01/2020	AMENDMENTS FOLLOWING CLIENTS	BG	DM	DM	SEB
R00	15/10/2019	SUITABLE FOR APPROVAL	BG	DM	DM	SEB

JACOBS
7th Floor, 2 Colmore Square, 38 Colmore Circus
Queensway, Birmingham, B4 6BN
Tel: +44(0)121 237 4000 www.jacobs.com

Client

Birmingham City Council

Project

**CLEAN AIR ZONE
(EARLY MEASURES-BUS PRIORITY SCHEMES)**

Drawing title

**HOCKLEY HILL
GENERAL ARRANGEMENT
SHEET 1 OF 3**

Drawing status		
SUITABLE FOR CONSTRUCTION		
Scale	1:500@A1	DO NOT SCALE
Jacobs No.	B2309014	
Client no.	1807-06	
Drawing number	B2309014-JAC-HGN-04_03-DR-CH-1001	Rev R01

© Copyright 2020 Jacobs U.K. Limited. The concepts and information contained in this document are the property of Jacobs. Use or copying of this document in whole or in part without the written permission of Jacobs constitutes an infringement of copyright. Limitation. This drawing has been prepared on behalf of, and for the exclusive use of, Jacobs Client, and is subject to, and issued in accordance with, the provisions of the contract between Jacobs and the Client. Jacobs accepts no liability or responsibility whatsoever for, or in respect of, any use of, or reliance upon, this drawing by any third party.