

ROAD MARKINGS DETAILS

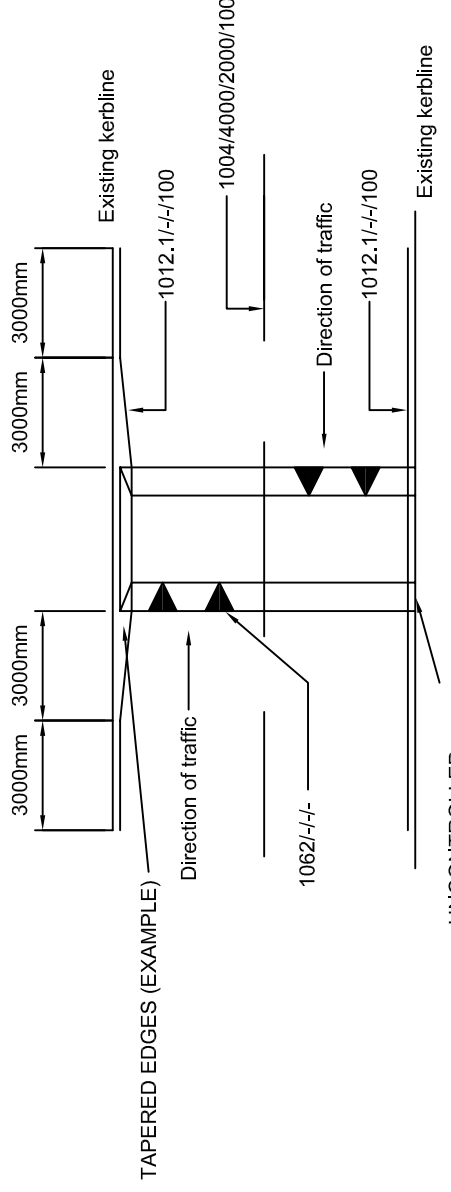

UNCONTROLLED PEDESTRIAN CROSSING POINT (EXAMPLE)
STANDARD USAGE

CONTROLLED PEDESTRIAN CROSSING POINT

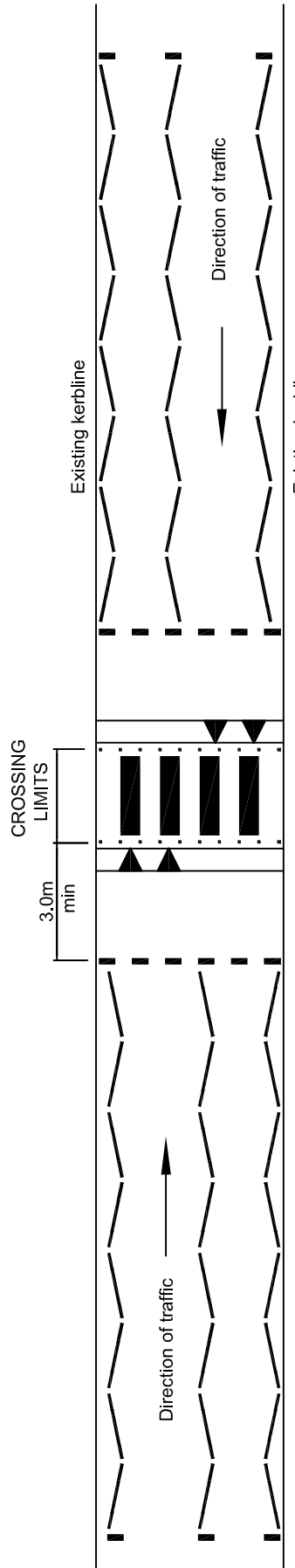

ZEBRA CROSSING

SIGNAL CONTROLLED CROSSING

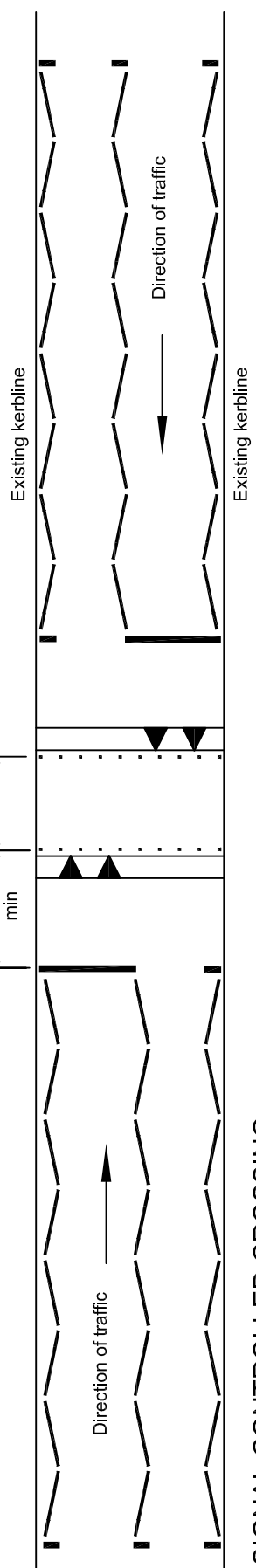

SIGNAL CONTROLLED CROSSING

Notes :-

- Road humps should not be constructed within 25m of a bridge, culvert or other structure.
- First hump to be 8.0 - 40.0m from junction or other gateway feature.
- Humps to be generally 40.0 - 100.0 metres apart.
- Exact locations for humps to be confirmed on site.
- Humps to be 75mm Maximum height unless stated otherwise.
- Carriageway markings to be laid in accordance with "The Traffic Signs Regulations and General Directions 2002".
- Carriageway markings to be laid in white thermoplastic screed with applied solid glass beads unless stated otherwise.
- Key to carriageway markings annotation :- Dia No Mark Gap Width
1004 / 4000 / 2000 / 100
- Buff coloured tactile paving to be used where flat-top road humps are located at uncontrolled pedestrian crossing points
- The Surface Course is to be S.M.A 10MM. Confirmation of Surface course requirements to be confirmed in writing to the Project Manager prior to commencement of works.
- The Binder Course is to be H.D.M 14MM. Confirmation of binder course requirements to be confirmed in writing to the Project Manager prior to commencement of works.

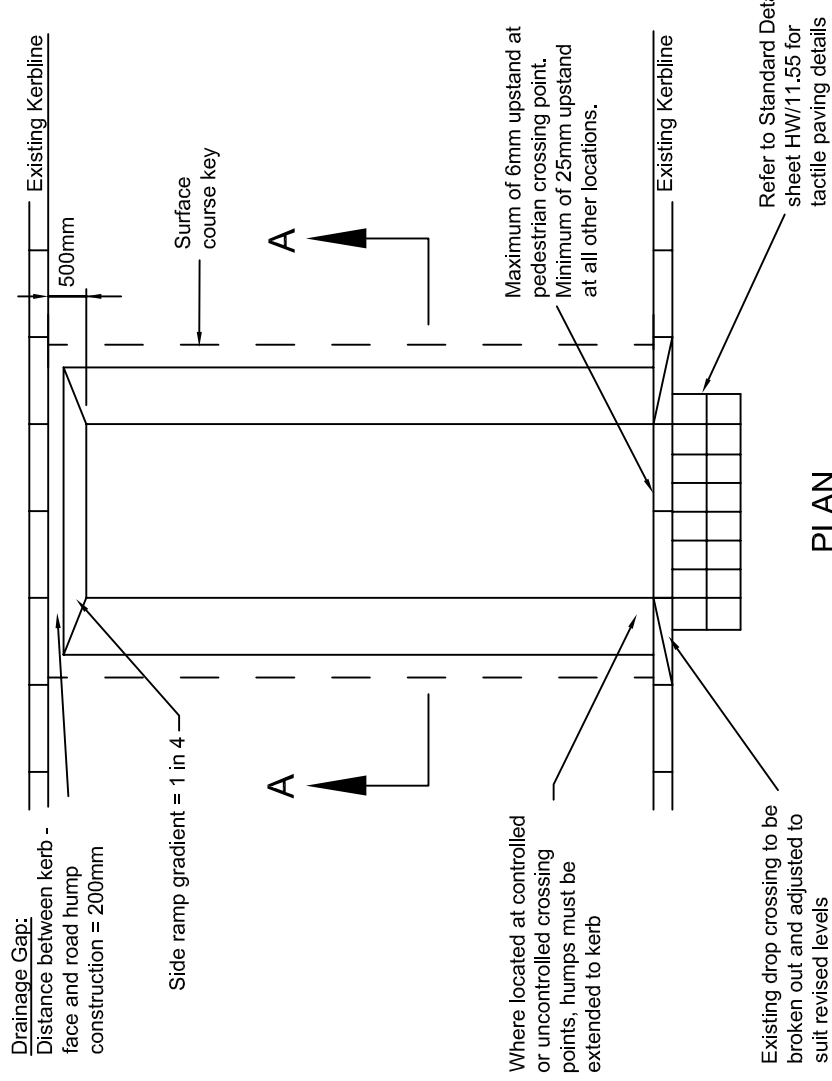

PLAN
(Showing alternative end details)

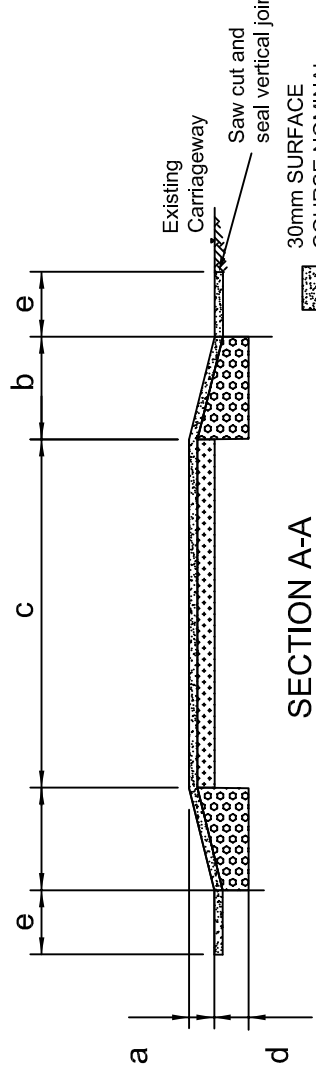

SECTION A-A

CONSTRUCTION DETAILS

| LOCATION | DIMENSIONS | | | | | |
|--|-----------------------|------|------|-------------------|------|------|
| | MINIMUM RAMP GRADIENT | a mm | b mm | c mm | d mm | e mm |
| Anywhere | 1:10 | 75 | 750 | 2500 | 75 | 300 |
| Controlled / uncontrolled crossing point | 1:15 | 100 | 1500 | limit of crossing | 75 | 300 |

| SCHEME | | DRAWING | | REVISIONS | |
|-------------------------|--|---------------------------|----|-----------|------|
| Birmingham City Council | | FLAT TOP ROAD HUMP DETAIL | | DATE | REV. |
| STANDARD DETAIL SHEETS | | DESIGNER | PM | 03/12/13 | PP |
| DRAWING STATUS | | GENERAL | | SCALE | NTS |
| DWG. No | | HW/7.51 | | | |



This detail is controlled by Birmingham City Council. Email - Transport.Projects@Birmingham.gov.uk