

CASTLE BROMWICH & BROMFORD

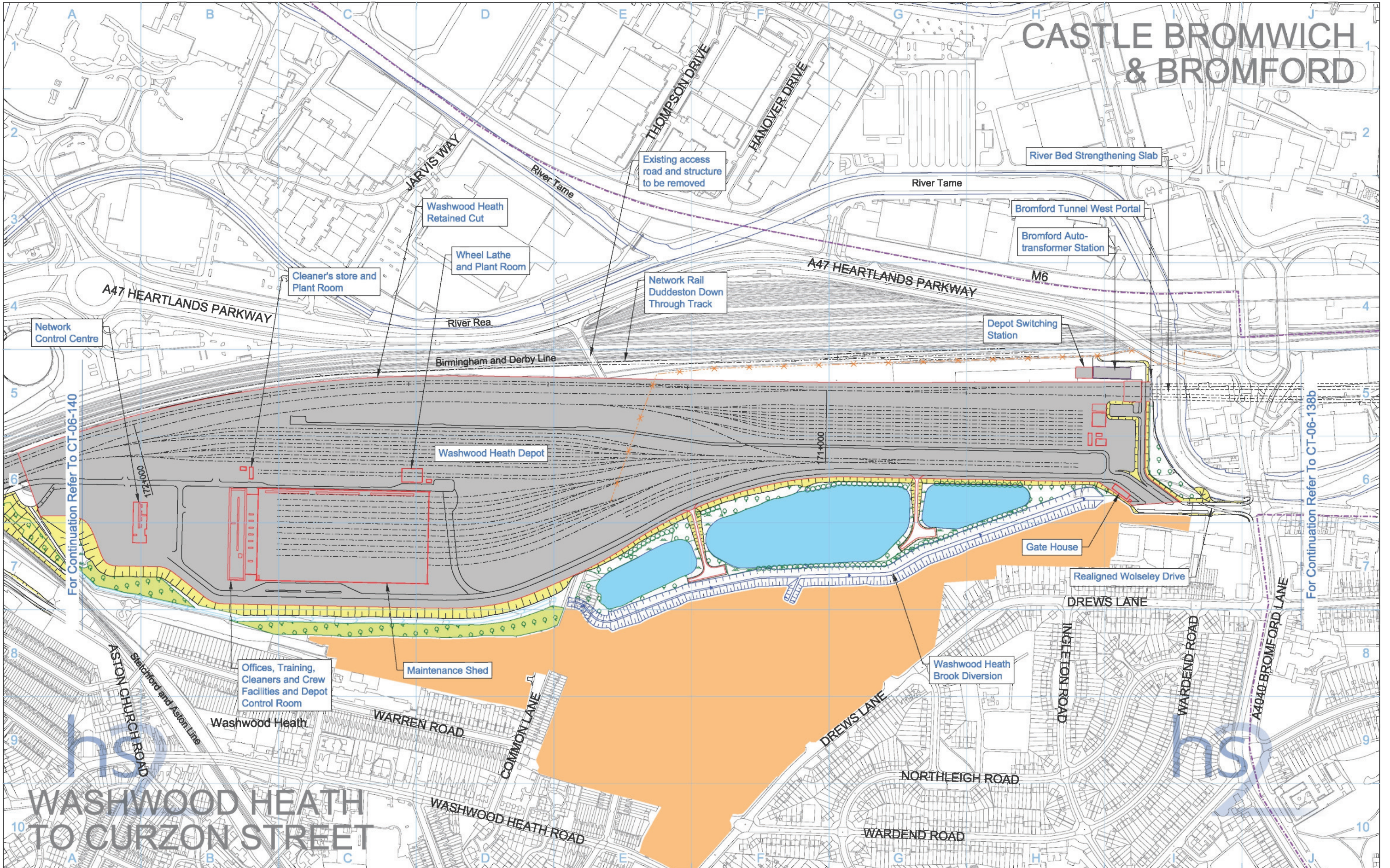

WASHWOOD HEATH TO CURZON STREET

Legend	
	Depot, station, headhouse or portal building
	Tunnel portal
	Electricity substation
	Land drainage area
	Ecological mitigation pond
	Balancing pond
	Replacement floodplain storage
	Woodland habitat creation
	Wetland habitat creation
	Grassland habitat creation
	Landscape mitigation planting (scrub / woodland)
	Grassed areas
	Sustainable placement
	Public realm
	Engineering earthworks
	Landscape earthworks
	Rail alignment formation
	Returned to suitable development use
	County boundary
	Borough / District boundary
	Community forum boundary
	Watercourse diversion
	Existing watercourse
	Ditches - new
	Hedgerow habitat creation
	Main utility works
	Existing public right of way (PRoW)
	New, diverted or realigned PRoW
	Stopped-up PRoW
	Tunnels external extent
	Rail alignment
	HS2 Access road
	Noise fence barrier
	Chainage (e.g. 10+000)

Map Number: **CT-06-139b**

Map Name: **Proposed Scheme**

Community Forum Area: **CFA26**
Washwood Heath to Curzon Street

Registered in England. Registration number 06791688
Registered office: Eland House, Bressenden Place, London SW1E 6DU

Scale at A3: 1:5,000

0 50 100 150 200 250
Metres

© Crown copyright and database rights 2013.
Ordnance Survey Licence Number 100048190.

Doc Number: C224-ARP-EV-DPL-040-206139 P06 Date: 29/10/13