

| IDNO MATERIALS LIST | | | | | |
|---|--------------------|--|---|--|--|
| DIS1114 Phase 2 & 3 Omega Park | | | | | |
| Description/ Application | Network Approved | Manufacturers Model/ Type Reference or Drawing No. | Approved Supplier | Approval Document Number | Comments |
| 2 x Complete Metering GRP Housing, brown and back mounting panel, Ref BS4800 08825 | Supplied by Others | Envico Code: Metering Enclosure with back board | Envico Engineering Ltd, Nantyrfin Road (south) Enterprise Park Llanmillet Swansea SA7 9HG | | Suitable for single phase termination |
| 100A Series Single Pole Cut-out KIT | IDNO | 54367-42 | WT Henley Limited Crete HUXFN Road Gravesend Kent DA11 9DA | | Kit contains 1xSP 100A cut-out, 1connector box, 1protection chamber, 60/80A label, phase/PME labels |
| 100A BS 88-2:2007 Table 905 (82mm Centres) | IDNO | 100MJ30-7 | Cooper Busman, Burton-on-the-Wolds Loughborough Leicestershire United Kingdom LE12 5TH Tel: 01509 882 661 | EA 05-4005 | Maximum Power Dissipation Dimensions to BS 88-5: 1988 Table 2 82mm centre for use on Radial Network and Services Close Tag |
| 35mm ² aluminium concentric single-phase service cable with solid aluminium conductor, XLPE insulation and copper concentric combined neutral/earth conductor and black PVC sheath | IDNO | 35 HYBRAL | N/A | Copper Cable Company, Interlink Park, Barton Hill NP, Coalville, Leicestershire LE67 1LA | For single-phase 100A PME domestic or commercial service |
| 95mm ² aluminium waveform mains cable with stranded aluminium conductor, XLPE insulation and copper concentric combined neutral/ earth conductor with an orange L50H sheath | IDNO | N/A | Copper Cable Company, Interlink Park, Barton Hill NP, Coalville, Leicestershire LE67 1LA | N/A | PME mains cable for use where flame retardant properties are required |
| 180mm ² aluminium waveform mains cable with stranded aluminium conductor, XLPE insulation and copper concentric combined neutral/ earth conductor with an orange L50H sheath | IDNO | N/A | Copper Cable Company, Interlink Park, Barton Hill NP, Coalville, Leicestershire LE67 1LA | N/A | PME mains cable for use where flame retardant properties are required |
| 300mm ² aluminium waveform mains cable with stranded aluminium conductor, XLPE insulation and copper concentric combined neutral/ earth conductor with an orange L50H sheath | IDNO | N/A | Nexans Logistics Ltd, Nexans House, Chesney World, Biskak HUXFN, Milton Keynes MK5 1LA | N/A | PME mains cable for use where flame retardant properties are required |
| Waveform mains service joint 70 to 185mm ² | IDNO | MS185W/UPN | Skame Electrical Developments Ltd Riverholme Works Huddersfield Road Holmfirth West Yorkshire HD9 3TN | 7.2 | Joint to be filled with standard UK Power Networks specification polyurethane resin |
| Waveform mains service joint 240 to 300mm ² | IDNO | MS300W/UPN | Skame Electrical Developments Ltd Riverholme Works Huddersfield Road Holmfirth West Yorkshire HD9 3TN | 8.8 | Joint to be filled with standard UK Power Networks specification polyurethane resin |
| Waveform 70 to 120mm ² | IDNO | SES/UPN | Skame Electrical Developments Ltd Riverholme Works Huddersfield Road Holmfirth West Yorkshire HD9 3TN | N/A | Heatshrink joint |
| Waveform to 185 to 300mm ² | IDNO | SE6/UPN | Skame Electrical Developments Ltd Riverholme Works Huddersfield Road Holmfirth West Yorkshire HD9 3TN | N/A | Heatshrink joint |
| Waveform to waveform Branch joint | IDNO | BMJ300W/UPN | Skame Electrical Developments Ltd Riverholme Works Huddersfield Road Holmfirth West Yorkshire HD9 3TN | 22.8 | Joint to be filled with standard UK Power Networks specification polyurethane resin |
| ESP Marked Tile tape for use up to 22kV | IDNO | N/A | Centriforce Product Limited Centriforce Products Ltd 14-16 Derby Road Liverpool L20 8EE www.centriforce.com | N/A | Used for single phase public lighting and domestic service cables |
| 125mm solid rigidduct (6m length) | IDNO | RB125X6 | Polypipe Civils Limited, Union Works Bishop Meadow Road Loughborough LE11 5RE www.polypipecivils.co.uk | N/A | LV, 11kV and 22kV mains cables |
| 400/5 7.5VA Class 0.5 | IDNO | N/A | ARW TRANSFORMER LTD Tel: 0141 638 1031 Fax: 0141 620 0200/2200 | ES-09-0002 | 400/5 LV CURRENT TRANSFORMER - TO COMPLY WITH SPECIFICATION NO. ES/M51.6/0.5 - 1980 |
| 400A Combined Cut-Out and CT Chamber | IDNO | CT Approved | Lucy Switchgear | N/A | Combined Unit |
| 600A Combined Cut-Out and CT Chamber | IDNO | CT Approved | Lucy Switchgear | N/A | Combined Unit |

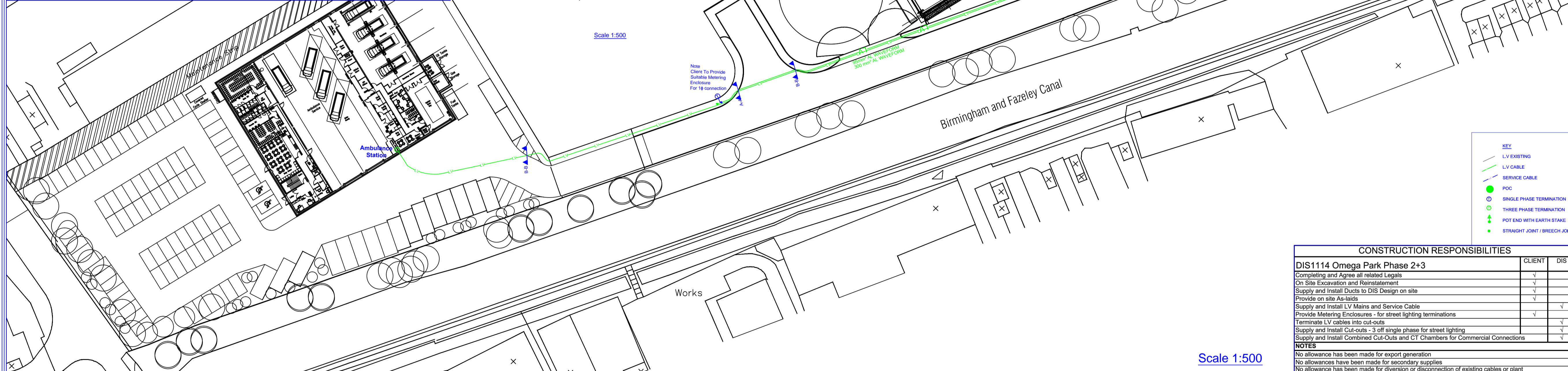

Scale 1:500

Scale 1:500

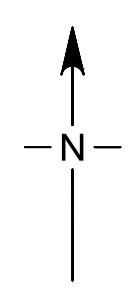
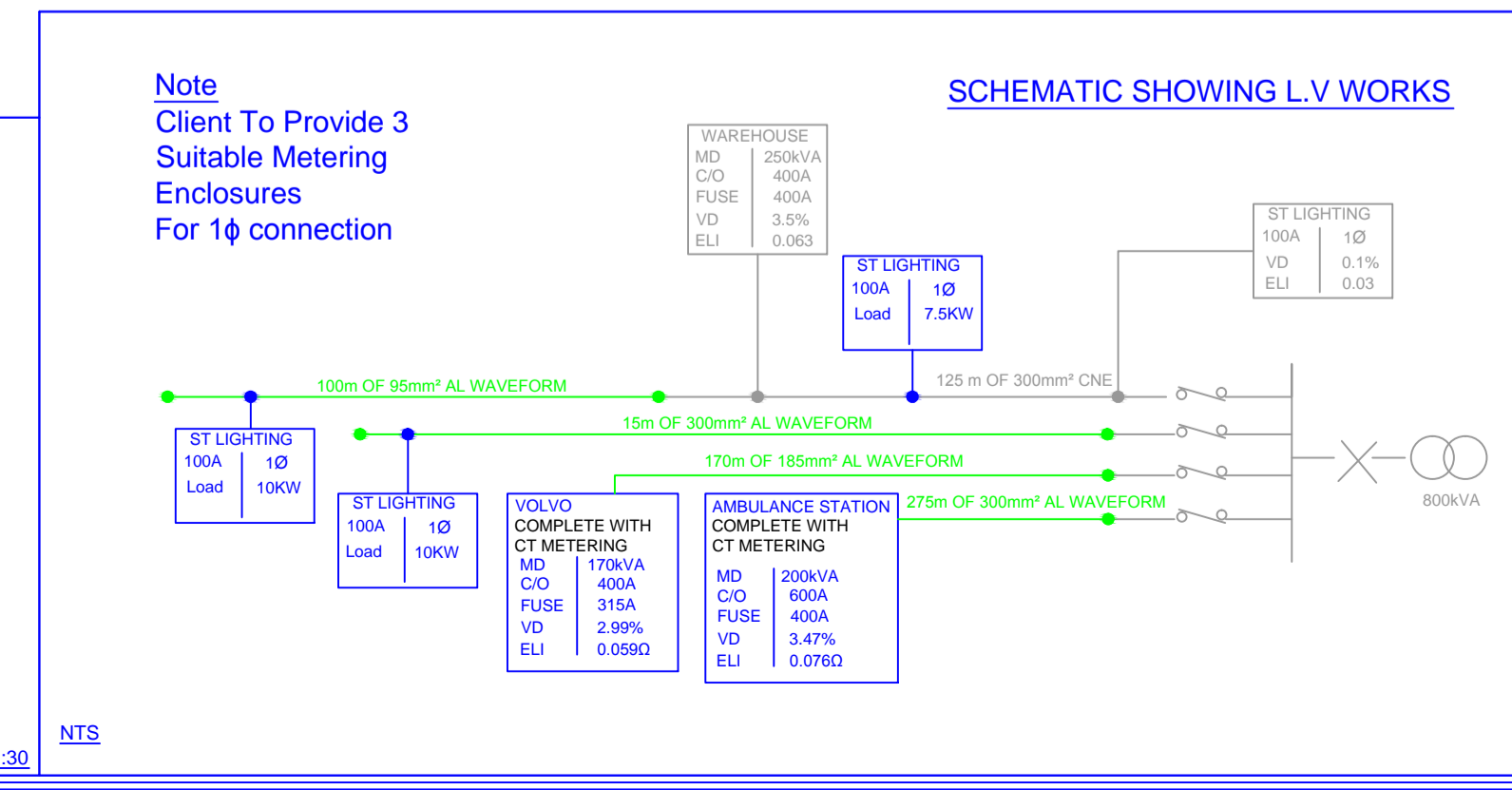
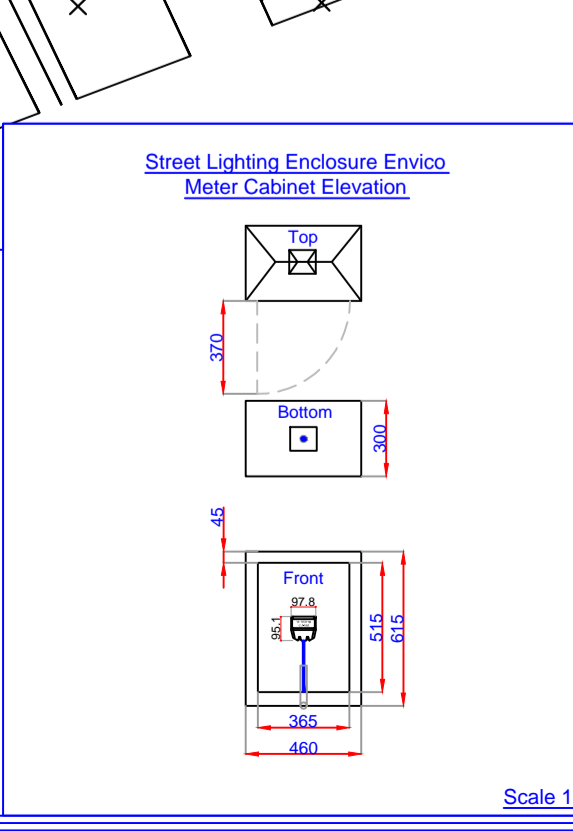
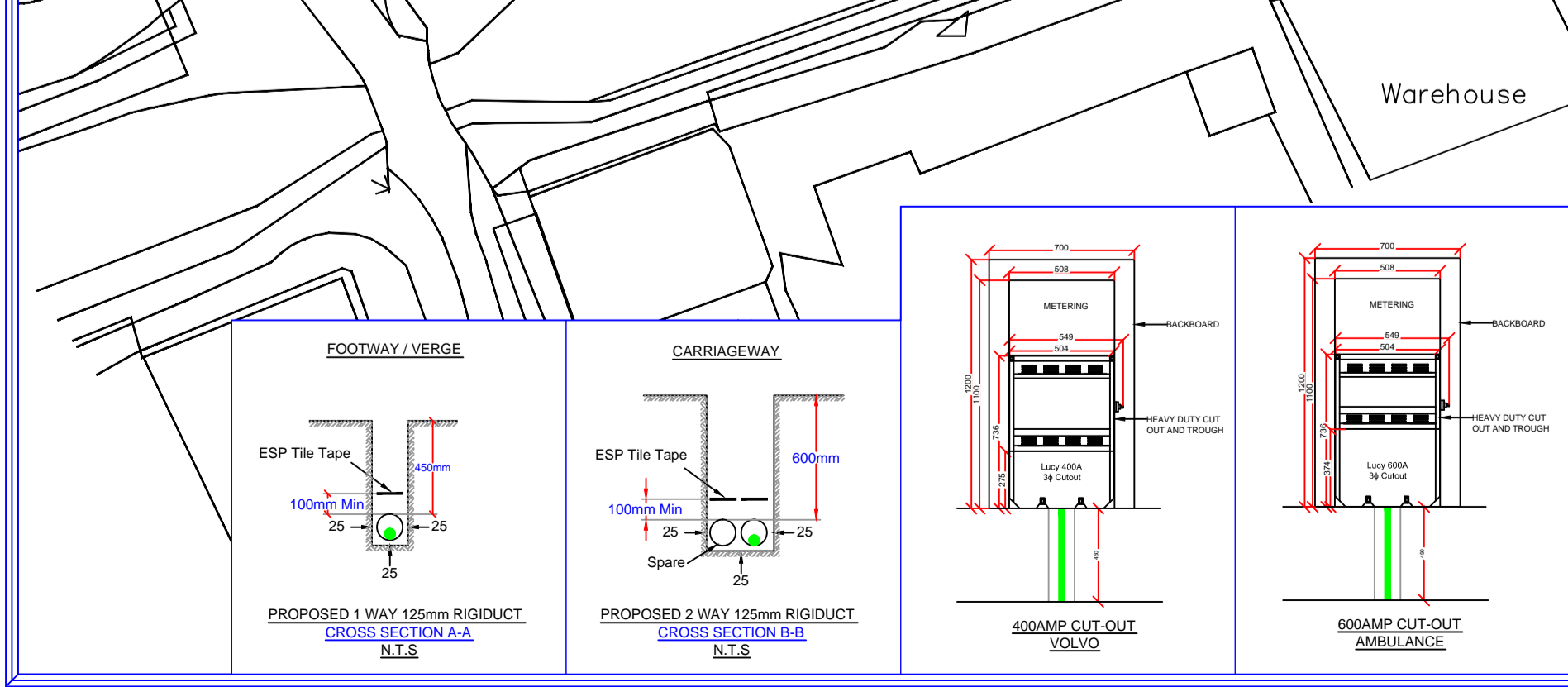

FOR APPROVAL

Our Reference: DIS 1114
 ESPE Reference: ESPE009
 Grid Reference: 413453.634 - 291275.256

Contact Details
 Reena Ahi
 Dragon Infrastructure Solutions
 The Dovecote
 High Street
 Kislingbury
 NN7 4AG
 Tel: 0845 362 0284
 Email: rahi@dragonsol.com

NERS Accreditation: COV3000183

Client: TIG SOLUTIONS LTD
 14a Millar Court,
 Seven Drove,
 Tewkesbury Business Park,
 Tewkesbury,
 Gloucestershire
 GL20 8DN
 Tel: 01684275004
 Email: plarr@tigsolutions.co.uk

Landowner: Opustand (Erdington) Ltd
 Melanie Booth
 49 High Street
 Henley-in-Ardren
 West Midlands
 B95 5AA
 TEL: 01564 794 008
 Space LLP
 Eldon House,
 2-3 Eldon Street,
 London,
 EC2M 7LS

Solicitor: Macfarlanes LLP
 20 Curator Street
 London
 EC4A 1LT
 Tel: 020 7831 9222

Main Contractor: TAGIBAL
 PMR Consultants
 29 Morria Boulevard,
 Baily Road,
 Coventry.

Site Details: Connection 1: 7.5kW
 Connection 2: 10 kW
 Connection 3: 10kW
 Ambulance Supply: 200kVA
 Volvo Supply: 170kVA

Total Site Load:

| REV | AMENDMENT | BY | DATE |
|-----|---|----|----------|
| A | Volvo and Ambulance supply added- TBS Removed | RA | 20.02.13 |



| CONSTRUCTION RESPONSIBILITIES | | |
|---|--------|-----|
| | CLIENT | DIS |
| DIS1114 Omega Park Phase 2+3 | | |
| Completing and Agree all related Legate | ✓ | |
| On Site Excavation and Reinstatement | ✓ | |
| Supply and Install Ducts to DIS Design on site | ✓ | |
| Provide on site As-laid | ✓ | |
| Supply and Install LV Mains and Service Cable | ✓ | |
| Provide Metering Enclosures - for street lighting terminations | ✓ | |
| Terminate LV cables into cut-outs | ✓ | |
| Supply and Install Cut-outs - 3 off single phase for street lighting | ✓ | |
| Supply and Install Combined Cut-Outs and CT Chambers for Commercial Connections | ✓ | |

NOTES
 No allowance has been made for export generation
 No allowances have been made for secondary supplies
 No allowance has been made for diversion or disconnection of existing cables or plant

CLIENT: TIG SOLUTIONS

PROJECT: OMEGA PARK
 CHESTER ROAD, ERDINGTON/BIRMINGHAM
 B24 9PY

TITLE: ESPE
 GENERAL ARRANGEMENT

SCALE: 1:500 @ A1
 DRAWN: RA
 DESIGNED: JT

CHECKED: JT
 AUTHORISED: TP
 FIRST ISSUE DATE: 14.02.13

TO BE READ IN CONJUNCTION WITH

DIS1114-GA-ESP

REV A

ORG. NO: 0715
 THIS DRAWING IS THE COPYRIGHT OF DRAGON INFRASTRUCTURE SOLUTIONS AND MAY NOT BE REPRODUCED OR AMENDED EXCEPT BY WRITTEN PERMISSION. NO LIABILITY WILL BE ACCEPTED FOR AMENDMENTS MADE BY OTHER PERSONS.

IMPORTANT WARNING

Information regarding the location of Geo Plant is given for your assistance and is intended for general guidance only. No guarantee is given of its accuracy.

It should not be relied upon in the event of excavations or other works being made near to Geo Plant which may exist at various depths and may deviate from the marked route.

FOR FURTHER INFORMATION PLEASE CONTACT
FISHER GERMAN ON 0845 0956910
REFERENCE NOS.....

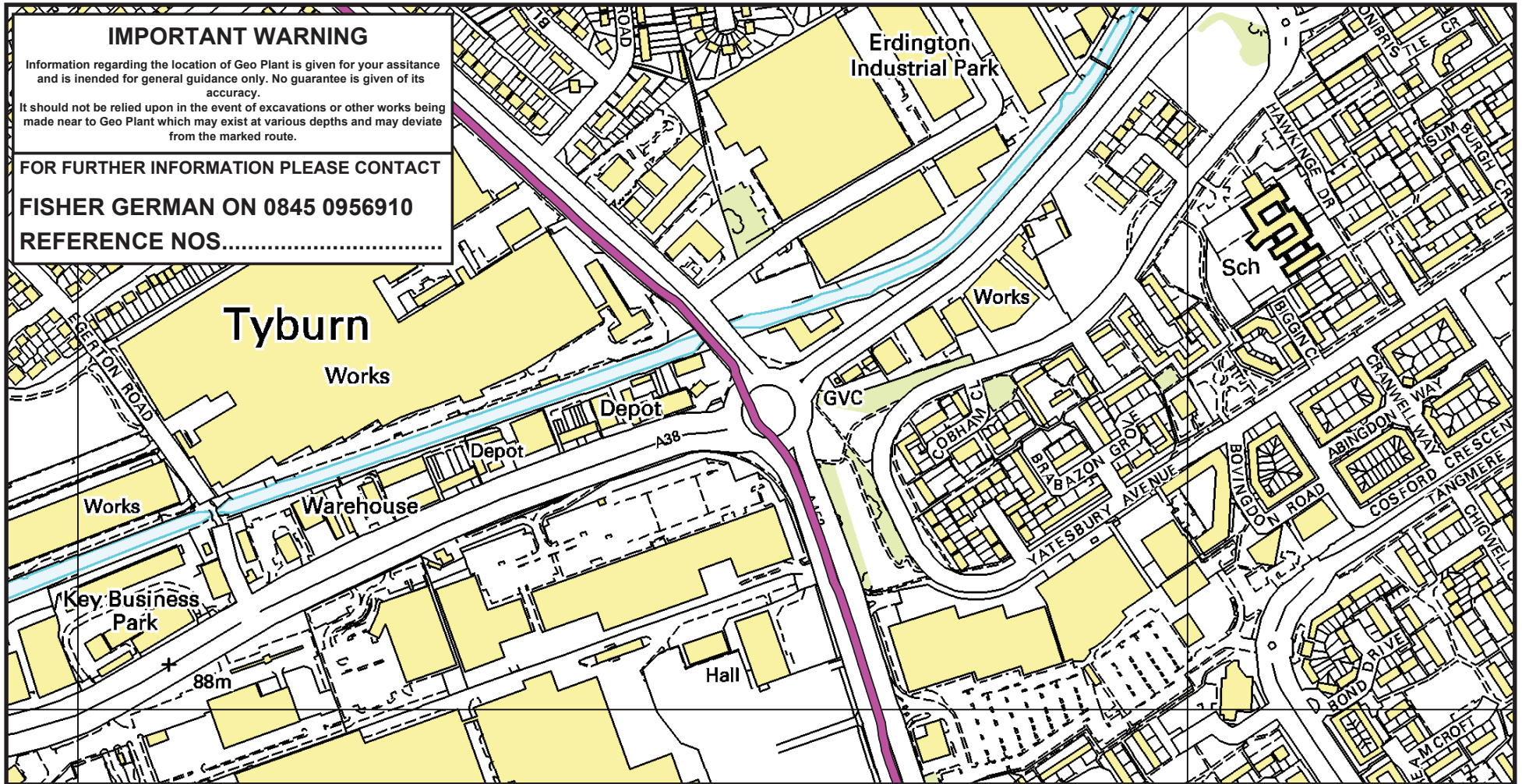

DATE: MARCH 2014

SCALE: NOT TO SCALE

 = GEO FIBRE OPTIC CABLE



Approximate position only
Contact Mark Up Services
Prior to works.

GEO NETWORKS LIMITED

LOCATION PLAN

"This plan must not be
copied or reproduced without
prior written consent from
the office of origin."



Fisher German LLP
PO Box 9198
Ashby de la Zouch
LE65 9BU
Tel: 0845 0956910
Fax: 0845 8620874
geo@fisherman.co.uk

Reproduced by permission of Ordnance Survey on behalf of HMSO.
Crown Copyright and database right 2009. All rights reserved.
Ordnance Survey Licence number 0100040487

THIS DRAWING IS PROTECTED BY COPYRIGHT. IT MAY NOT BE REPRODUCED
IN ANY FORM OR BY ANY MEANS FOR ANY PURPOSE WITHOUT THE WRITTEN
PERMISSION OF FISHER GERMAN LLP CHARTERED SURVEYORS.
FISHER GERMAN LLP IS LIMITED LIABILITY PARTNERSHIP.
REGISTERED IN ENGLAND AND WALES. REGISTERED NUMBER: OC317554

INSTALCOM LTD

CIVILS AND CABLING INSTALLATION SPECIALIST

Instalcom House, Manor Way, Borehamwood, Hertfordshire, WD6 1QH

Telephone: 0208 731 4600 Fax: 0208 731 4601 Email: plantenquiries@instalcom.co.uk

16 April 2014

Dear Sir or Madam,

Your Ref: Tyburn Roundabout

Our Ref: E03/14-0787

With reference to your enquiry regarding the above noted location, I enclose the drawings on behalf of LEVEL 3, GLOBAL CROSSING (UK) LTD, GLOBAL CROSSING PEC, FIBERNET UK LTD and FIBRESPAN LTD indicating the approximate position of services in this area.

I would draw your attention to the fact that while the position of the plant has been shown as accurately as possible, the information is intended as a general guide only and must not be relied upon in the event of any excavations or other work in the vicinity. I would remind you that the onus remains on you to determine the exact position for example by a hand excavated trial hole. Instalcom accepts no liability for claims arising from any inaccuracy, omissions or errors contained herein. If you would like to query the location further, please email us accordingly and we can arrange an in depth survey, which will be charged at a cost. Enclosed is a guide to excavation works around existing plant.

Instalcom responds to plant enquiries for Level 3, GLOBAL CROSSING (UK) LTD, GLOBAL CROSSING PEC and FIBERNET UK LTD simultaneously and therefore you only need send one copy of a plant enquiry to cover all of these companies. As we are moving towards a fully electronic database we urge our customers to request plant enquiries by email which will result in a higher level of service, please forward future plant enquiries to plantenquiries@instalcom.co.uk

If you require any further information, please do not hesitate to contact me.

Plant Protection Administrator

Instalcom Limited

Instalcom House,

Manor Way,

Borehamwood,

WD6 1QH

E mail:- plantenquiries@instalcom.co.uk

Phone:- 020 8731 4600

Fax:- 020 8731 4601

www.instalcom.co.uk



Google earth

feet
meters



Google earth



SPECIAL REQUIREMENTS IN RELATION TO LEVEL 3 PLANT

1. In this special requirement, the following terms shall have the meanings assigned to it :-
 - a. "Company" means Level 3.
 - b. "Company Representative" means the staff of Level 3 or its Authorized Representatives and Agents.
 - c. "Apparatus" means all surface or sub-surface equipment and plant including any associated cabling and/or ducting owned leased or rented by Level 3.
2. Before commencing any work or moving heavy plant or equipment over any portion of the site, the contractor shall confirm details of the Apparatus, owned, leased or rented by the Company, within the site with the Company Representative, who can be contacted at the following point: -

**Instalcom Limited
Instalcom House
Manor Way
Borehamwood
Hertfordshire
WD6 1QH
Tel: 0208 731 4600
Fax: 0208 731 4601
E-mail: plantenquiries@instalcom.co.uk**

3. Where such details show that the works or the movement of plant or equipment may endanger the Apparatus of the Company the Contractor must give the Company Representative at least 7 days written notice of the date on which it is intended to commence such works of the movement of plant and equipment in order that the presence of any sub-surface apparatus can be indicated by markers to be supplied by the Company and placed by the Contractor under the supervision of a Company Representative. The Contractor shall ensure that all Company Apparatus, particularly surface running cabling is adequately protected from damage and such protective measures shall be approved by the Company Representative.
4. In the event of a Company marker being disturbed for any reason, it shall not be replaced other than in the exact position of its former depth unless the repositioning is carried out at the direction and under the supervision of a Company Representative.
5. The Contractor shall take particular care in relation to the protection of Company Apparatus, where such Apparatus includes the presence within the site of optical fibre cabling. The contractor should particularly note that the damage to such Apparatus is extremely disruptive to the Company network and costly to reinstate. The Contractor shall make every effort to avoid the disturbance of Company Apparatus more than is absolutely necessary for the completion of the works in accordance with the contract.

6. When excavating around, moving or backfilling around Company Apparatus, the Company Representative shall be given adequate notice, which shall not be less than 3 days, of the contractor's intentions in order that he may supervise the works. The Contractor should note that the normal depth of cover for Company Apparatus and ducts are as follows: -
- a. Carriageways 600mm
 - b. Footways 350mm
 - c. Verges 450mm

These minimum depths of cover should be maintained wherever possible.

Where the minimum depths of cover cannot be maintained, the Contractor shall carry out the instructions of the Company Representative for the protection of Company Apparatus.

Where cables are not in duct and the required depth of cover cannot be maintained, such cables as are affected shall be enclosed and protected in UPVC duct or equivalent materials as supplied by the Company and by the method directed by the Company Representative.

With regard to excavation in the vicinity of Company Apparatus the Contractor should have particular regard to the possibility of reduced cover and the encountering of such Company Apparatus at depths of cover less than that given at **a, b and c above**.

7. All excavation adjacent to Company Apparatus is to be carried out by hand until the exact extent and/or location of Company Apparatus is known. Mechanical borers and/or excavators shall not be used within 1.0m of Company Apparatus without the supervisory presence of a Company Representative, To prevent any movement of Company Apparatus during excavations, complete shuttering shall be used as directed by the Company Representative if:-
- a. Excavation is deeper than the depth of cover of adjacent Company Apparatus.
 - b. Excavation is within 1.0m of Company Apparatus in stable ground.
 - c. Excavation is within 5.0m of Company Apparatus in unstable ground.

If for the completion of the works, the Contractor intends using any of the following: -

- a. Pile driving equipment within 10.0m of Company Apparatus.
- b. Explosives within 20.0m of Company Apparatus.
- c. Laser equipment within 10.0m of Company Apparatus.

The Contractor shall advise the Company Representative, giving at least 7 working days written notice in order that any special protective measure for the Company Apparatus affected may be arranged.

8. All Company manhole, joint box and /or other access points and chambers within the site shall be kept clear and unobstructed. Access for vehicles, winches, cable drums and/or further equipment required by the Company for the maintenance of its Apparatus, must be maintained at all reasonable times. The Contractor should particularly note that footway type jointing chambers are not specified for carriageway loadings and will need to be adequately protected and/or demolished and rebuilt under the supervision of a Company Representative where such chambers are likely to be placed at risk, either temporarily or permanently, from the movement of plant and/or equipment on the site.

9. The covers to Company chambers and/or Apparatus shall only be lifted by means of appropriate keys obtained from the Company Representative and under the direct supervision of the Company Representative. No employee of the Contractor or of any sub-contractor employed by the Contractor shall enter any chamber and/or Apparatus of the Company unless under the supervision of the Company Representative and in any case not before the mandatory gas check has been carried out in the presence of the Company Representative and such checks have shown it to be safe to enter the chamber and/or Apparatus of the Company.

The Company Representatives shall be given reasonable access to all Company Apparatus and chambers when required.

10. In the event of any damage whatsoever to Company Apparatus, the Contractor shall immediately inform the Company Representative and report the occurrence immediately by contacting the Company as follows:-

Telephone:-

0208 731 4600
Mon-Fri Office Hours (Instalcom Head Office)

0208 510 3111/3101
Out of Office Hours (24Hr Level 3 Network Operations Centre)

11. The above requirements do not relieve the Contractor of any of his obligations under the Contract.

The accuracy of information on the plans cannot be guaranteed and no liability can be accepted for errors or omissions.

Damage to Communications Plant is Expensive – Please Take Care.

WARNING! This area contains Gas Mains Operating at High Pressure (in excess of 7 bar) and Intermediate Pressure (between 2 and 7 bar). Before excavating in the area contact the Plant Protection team on 0800 688 588 or plantprotection@nationalgrid.com.

WARNING! This area contains contact zones.

WARNING! This area contains double handed / 118 zones. This layer is not visible on the map

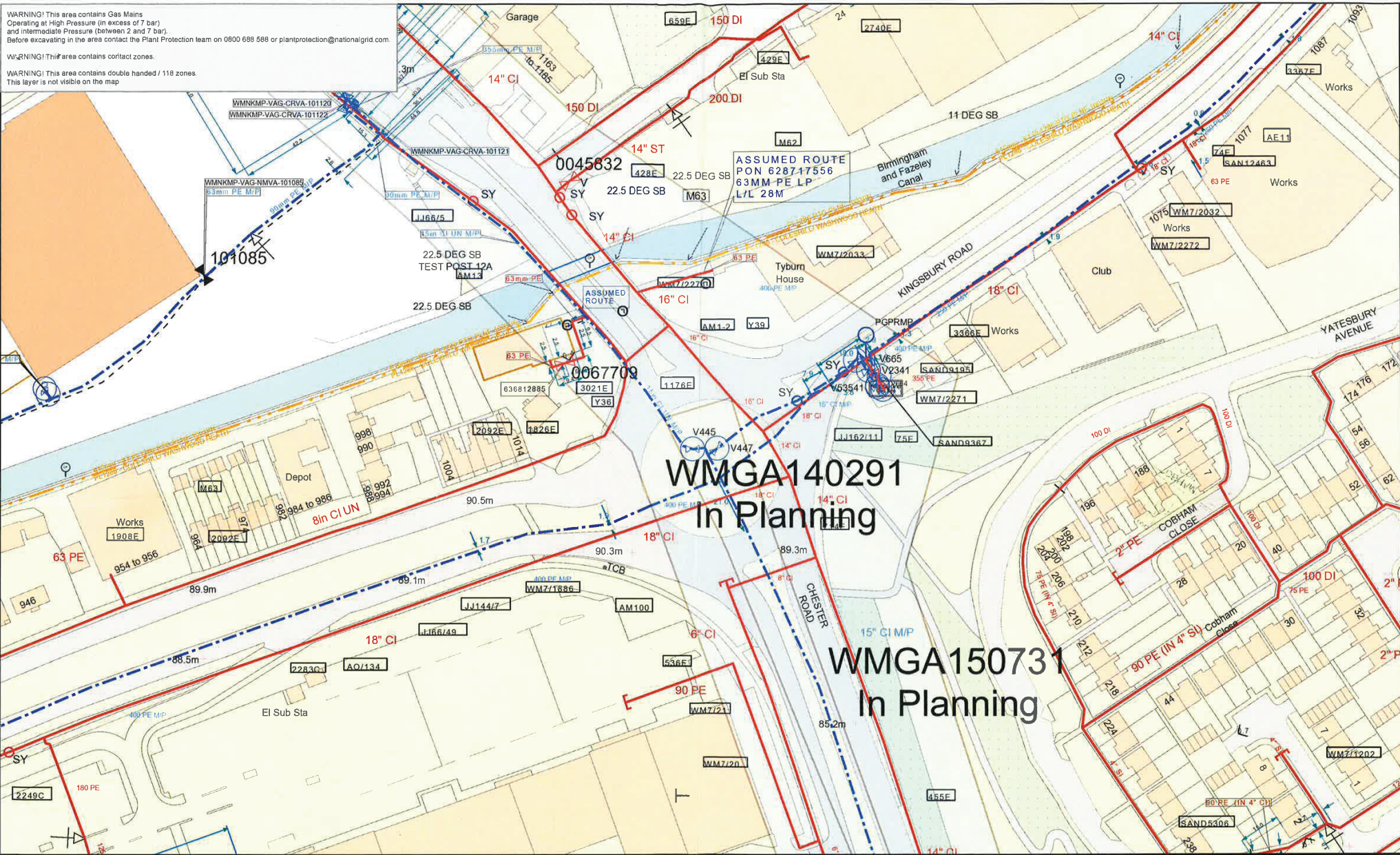

SCALE: 1:1250
 USER ID: GOC01
 DATE: 17/03/2014
 NRSWA RESPONSE
 MAP REF: SP1391
 CENTRE: 413618,291282

Some examples of pipe items:

| | | | | |
|-------|----------------|--------|-----------------|-----------------|
| Valve | Depth of Cover | Symbol | Diameter Change | Material Change |
|-------|----------------|--------|-----------------|-----------------|

This plan shows those pipes owned by National Grid Gas plc in their role as a Licensed Gas Transporter (GT). Gas pipes owned by other GTs, or otherwise privately owned, may be present in this area. Information with regard to such pipes should be obtained from the relevant owners. The information shown on this plan is given without warranty, the accuracy thereof cannot be guaranteed. Service pipes, valves, symbols, stub connections, etc. are not shown but their presence should be anticipated. No liability of any kind whatsoever is accepted by National Grid Gas plc or their agents, servants or contractors for any error or omission. Safe digging practices, in accordance with HSG47, must be used to verify and establish the actual position of mains, pipes, services and other apparatus on site before any mechanical plant is used. It is your responsibility to ensure that this information is provided to all persons (either direct labour or contractors) working for you on or near gas apparatus. The information included on this plan should not be referred to beyond a period of 28 days from the date of issue.

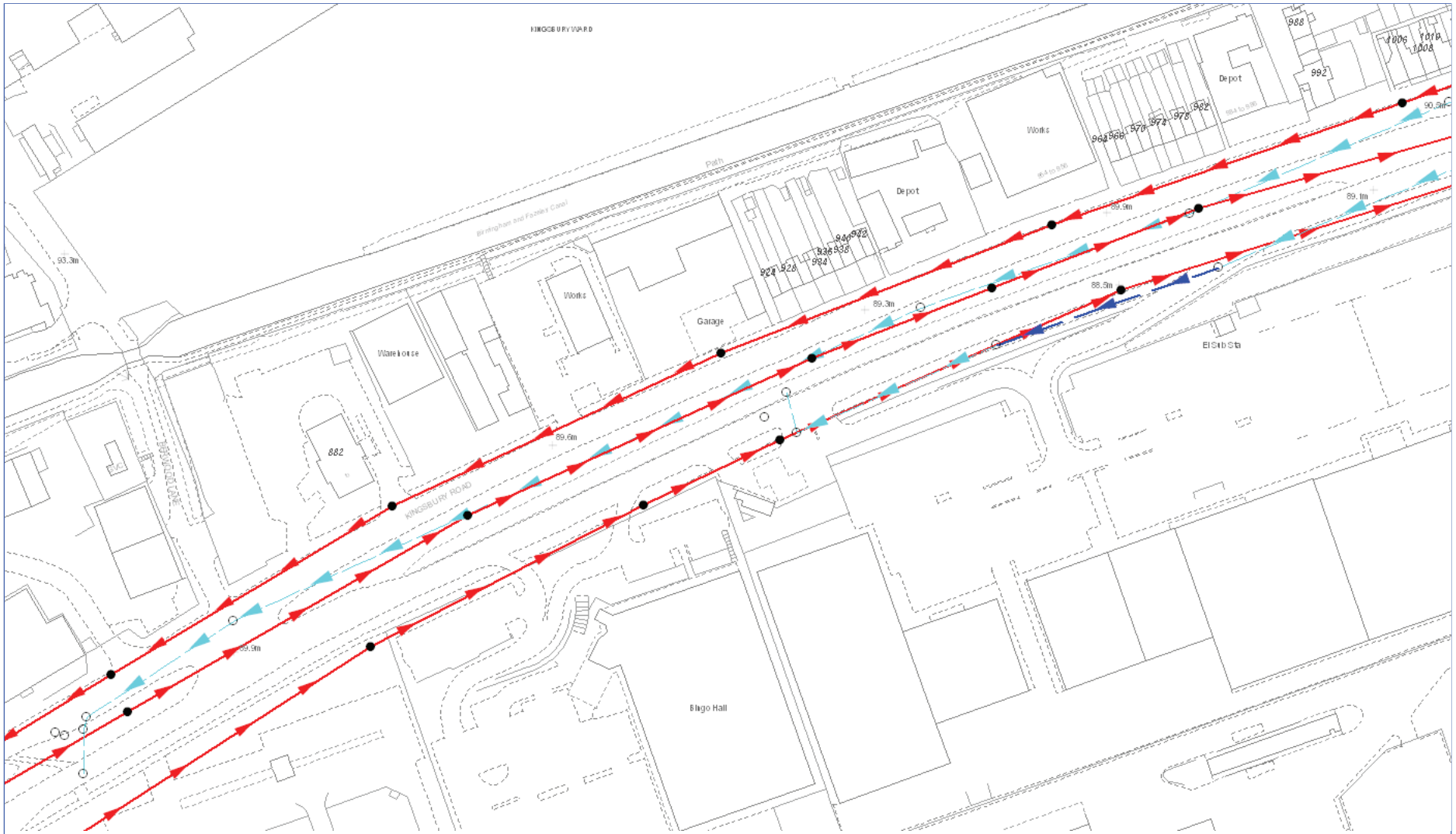

| | | |
|--|--|--|
| | | |
| | | |
| | | |
| | | |
| | | |
| | | |
| | | |
| | | |
| | | |



Severn Trent Water Limited
 Asset Data Management
 PO Box 5344
 Coventry
 CV3 9FT
 Telephone: 0845 601 6616

Sewer Record

O/S Map scale: Approx. 1:1250
 Date of Issue: 04 03 2011
 Do not scale off this drawing

This map is centered upon OS Grid Ref:
 x - 413313.0 y - 291157.0

1. This plan and any information supplied with it is furnished as a general guide, is only valid at the date of issue and no warranty as to its correctness is given or implied. In particular this plan and any information shown on it must not be relied upon in the event of any development or works (including but not limited to excavations) in the vicinity of Severn Trent's assets or for the purposes of determining the suitability of a point of connection to the sewerage or distribution systems.
 2. The material contained in this drawing has been based upon the Ordnance Survey Map by SEVERN TRENT WATER Ltd. by permission of Ordnance Survey on behalf of the controller of her Majesty's Stationery Office. © Crown Copyright © SEVERN TRENT WATER Ltd. 66 100018202
 3. Document users other than SEVERN TRENT WATER business users are advised that this document is provided for reference purpose only and no further copies should be made.

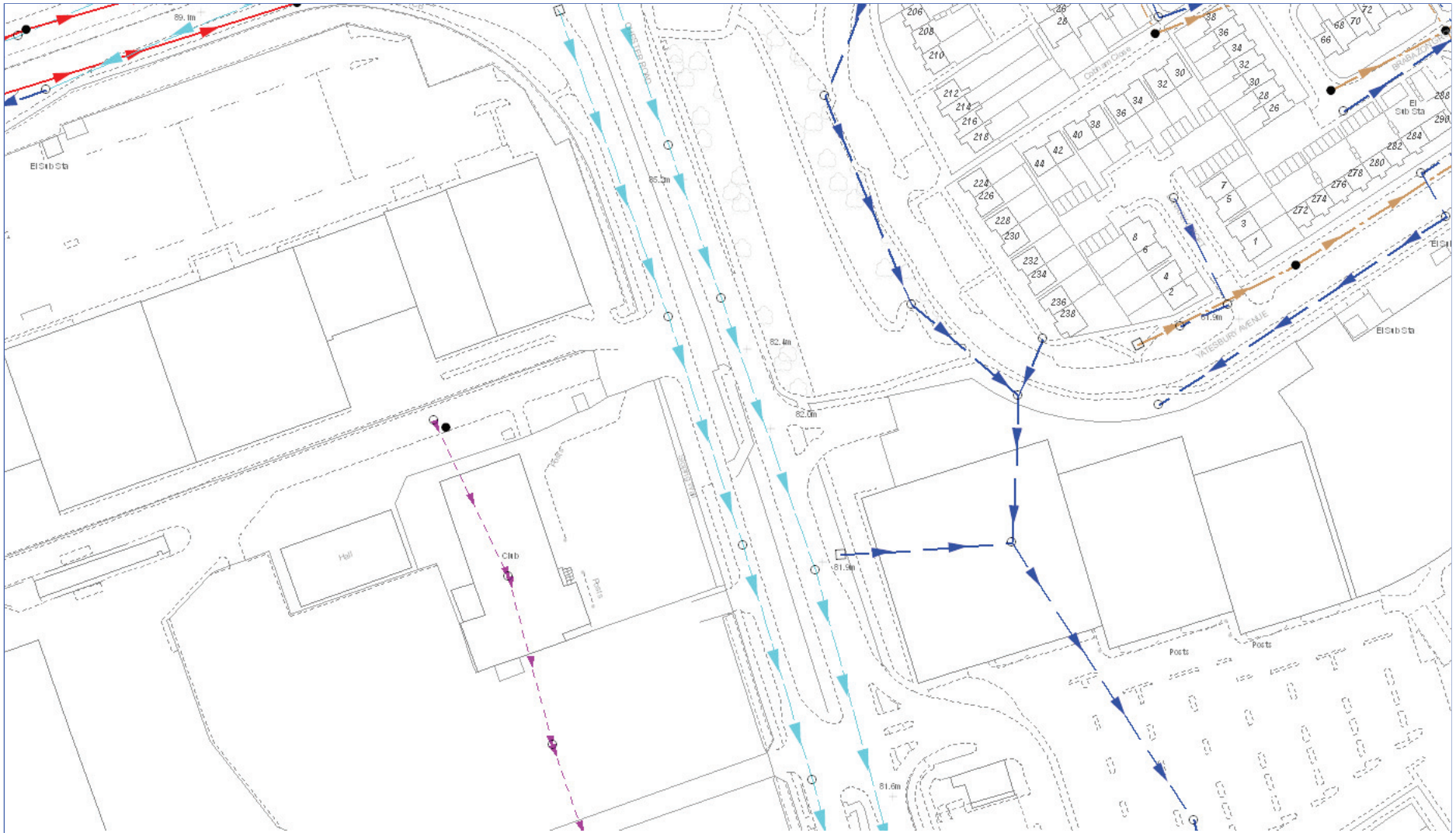

| | | |
|--|--|--|
| | | |
| | | |
| | | |
| | | |
| | | |
| | | |
| | | |
| | | |
| | | |



Severn Trent Water Limited
 Asset Data Management
 PO Box 5344
 Coventry
 CV3 9FT
 Telephone: 0845 601 6616

Sewer Record

O/S Map scale: Approx. 1:1250
 Date of Issue: 04 03 2011
 Do not scale off this drawing

This map is centered upon OS Grid Ref:
 x - 413688.0 y - 291100.0

1. This plan and any information supplied with it is furnished as a general guide, is only valid at the date of issue and no warranty as to its correctness is given or implied. In particular this plan and any information shown on it must not be relied upon in the event of any development or works (including but not limited to excavations) in the vicinity of Severn Trent's assets or for the purposes of determining the suitability of a point of connection to the sewerage or distribution systems.
 2. The material contained in this drawing has been based upon the Ordnance Survey Map by SEVERN TRENT WATER Ltd. by permission of Ordnance Survey on behalf of the controller of her Majesty's Stationery Office. © Crown Copyright © SEVERN TRENT WATER Ltd. 66 100018202
 3. Document users other than SEVERN TRENT WATER business users are advised that this document is provided for reference purpose only and no further copies should be made.

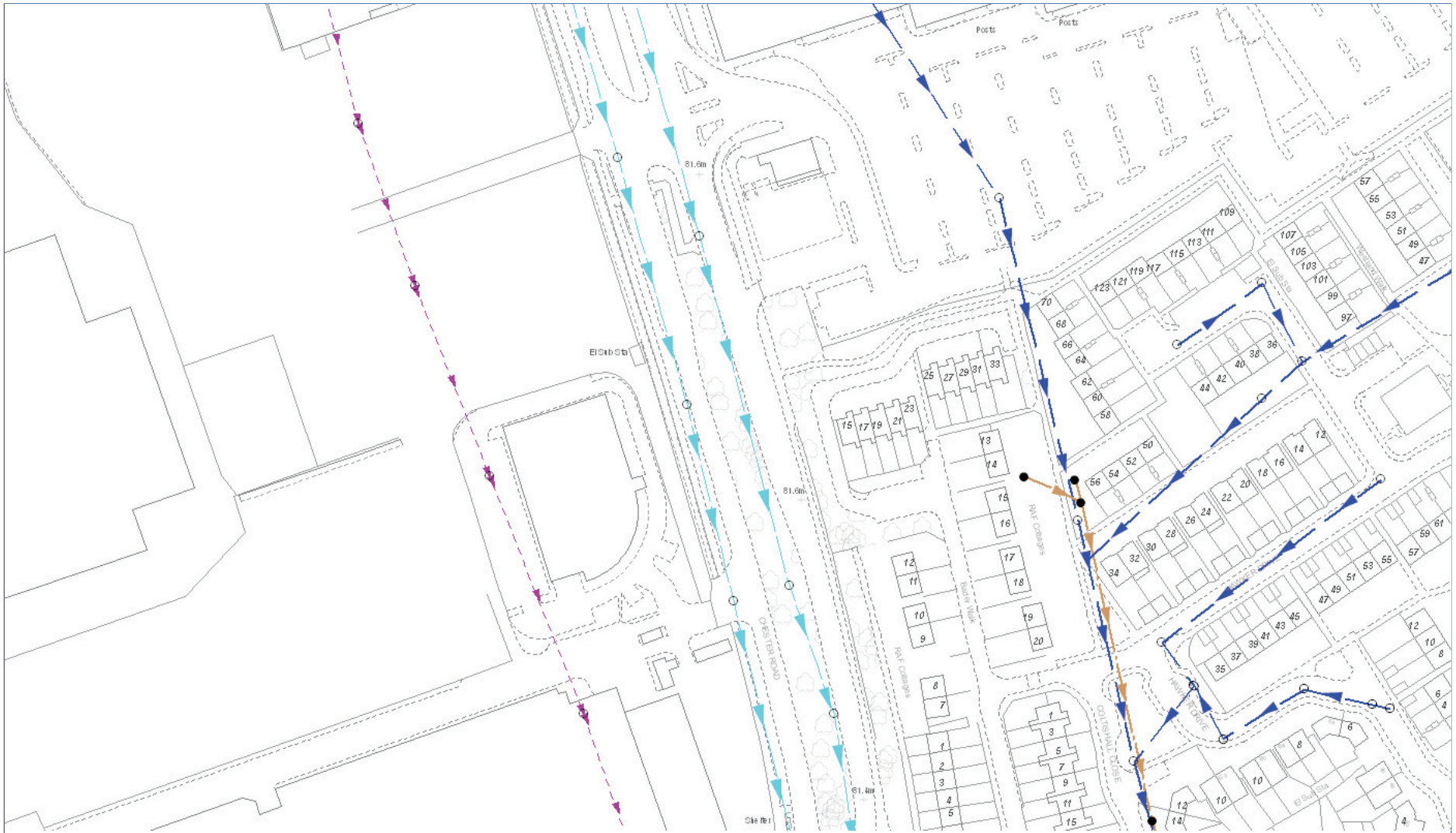

| | | |
|--|--|--|
| | | |
| | | |
| | | |
| | | |
| | | |
| | | |
| | | |
| | | |
| | | |
| | | |



Severn Trent Water Limited
 Asset Data Management
 PO Box 5344
 Coventry
 CV3 9FT
 Telephone: 0845 601 6616

Sewer Record

O/S Map scale: Approx. 1:1250
 Date of Issue: 04 03 2011
 Do not scale off this drawing

This map is centered upon OS Grid Ref:
 x - 413750.0 y - 290901.0

1. This plan and any information supplied with it is furnished as a general guide, is only valid at the date of issue and no warranty as to its correctness is given or implied. In particular this plan and any information shown on it must not be relied upon in the event of any development or works (including but not limited to excavations) in the vicinity of Severn Trent's assets or for the purposes of determining the suitability of a point of connection to the sewerage or distribution systems.
 2. The material contained in this drawing has been based upon the Ordnance Survey Map by SEVERN TRENT WATER Ltd. by permission of Ordnance Survey on behalf of the controller of her Majesty's Stationary Office. © Crown Copyright © SEVERN TRENT WATER Ltd. 66 100018202
 3. Document users other than SEVERN TRENT WATER business users are advised that this document is provided for reference purpose only and no further copies should be made.

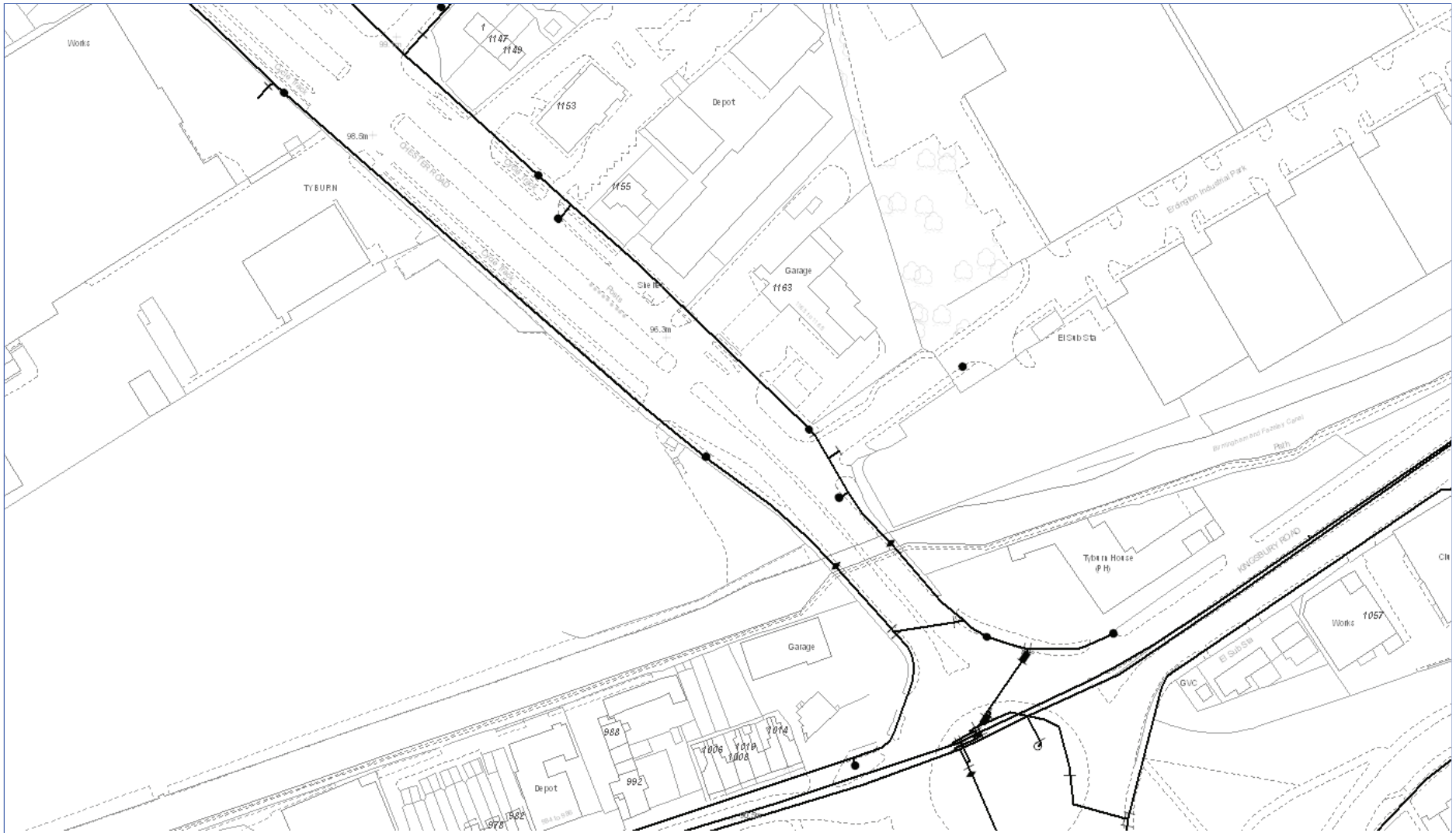

| | | |
|--------------------|-------------------|-----------------|
| Water main | Aqueduct | Abandoned pipe |
| Fire main | Water valve | Air valve |
| Fire hydrant | Washout hydrant | Bulk meter |
| Non-return valve | Anode | Discharge |
| High voltage cable | Low voltage cable | Instrumentation |
| Duct | | |



Severn Trent Water Limited
 Asset Data Management
 PO Box 5344
 Coventry
 CV3 9FT
 Telephone: 0845 601 6616

Water Mains Record

O/S Map scale: Approx. 1:1250
 Date of Issue: 04 03 2011
 Do not scale off this drawing

This map is centered upon OS Grid Ref:
 x - 413532.0 y - 291384.0

1. This plan and any information supplied with it is furnished as a general guide, is only valid at the date of issue and no warranty as to its correctness is given or implied. In particular this plan and any information shown on it must not be relied upon in the event of any development or works (including but not limited to excavations) in the vicinity of Severn Trent's assets or for the purposes of determining the suitability of a point of connection to the sewerage or distribution systems.
2. The material contained in this drawing has been based upon the Ordnance Survey Map by SEVERN TRENT WATER Ltd, by permission of Ordnance Survey on behalf of the controller of her Majesty's Stationary Office. © Crown Copyright & SEVERN TRENT WATER Ltd. & 100018202
3. Document users other than SEVERN TRENT WATER business users are advised that this document is provided for reference purpose only and no further copies should be made.

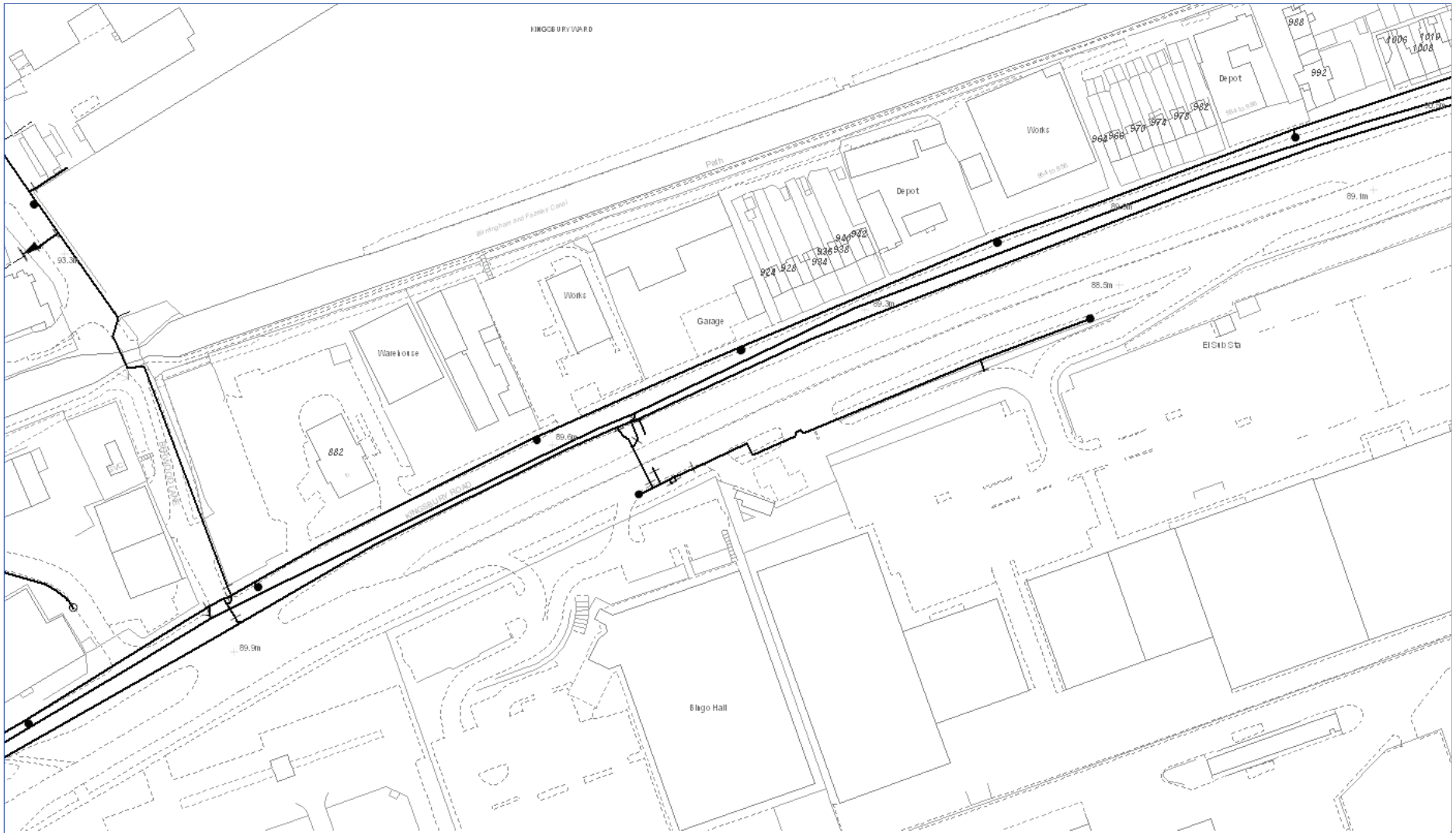

Severn Trent Water Limited
 Asset Data Management
 PO Box 5344
 Coventry
 CV3 9FT
 Telephone: 0845 601 6616

Water Mains Record

O/S Map scale: Approx. 1:1250
 Date of Issue: 04 03 2011
 Do not scale off this drawing

This map is centered upon OS Grid Ref:
 x - 413313.0 y - 291157.0

1. This plan and any information supplied with it is furnished as a general guide, is only valid at the date of issue and no warranty as to its correctness is given or implied. In particular this plan and any information shown on it must not be relied upon in the event of any development or works (including but not limited to excavations) in the vicinity of Severn Trent's assets or for the purposes of determining the suitability of a point of connection to the sewerage or distribution systems.
 2. The material contained in this drawing has been based upon the Ordnance Survey Map by SEVERN TRENT WATER Ltd, by permission of Ordnance Survey on behalf of the controller of her Majesty's Stationary Office. © Crown Copyright & SEVERN TRENT WATER Ltd. & 100018202
 3. Document users other than SEVERN TRENT WATER business users are advised that this document is provided for reference purpose only and no further copies should be made.

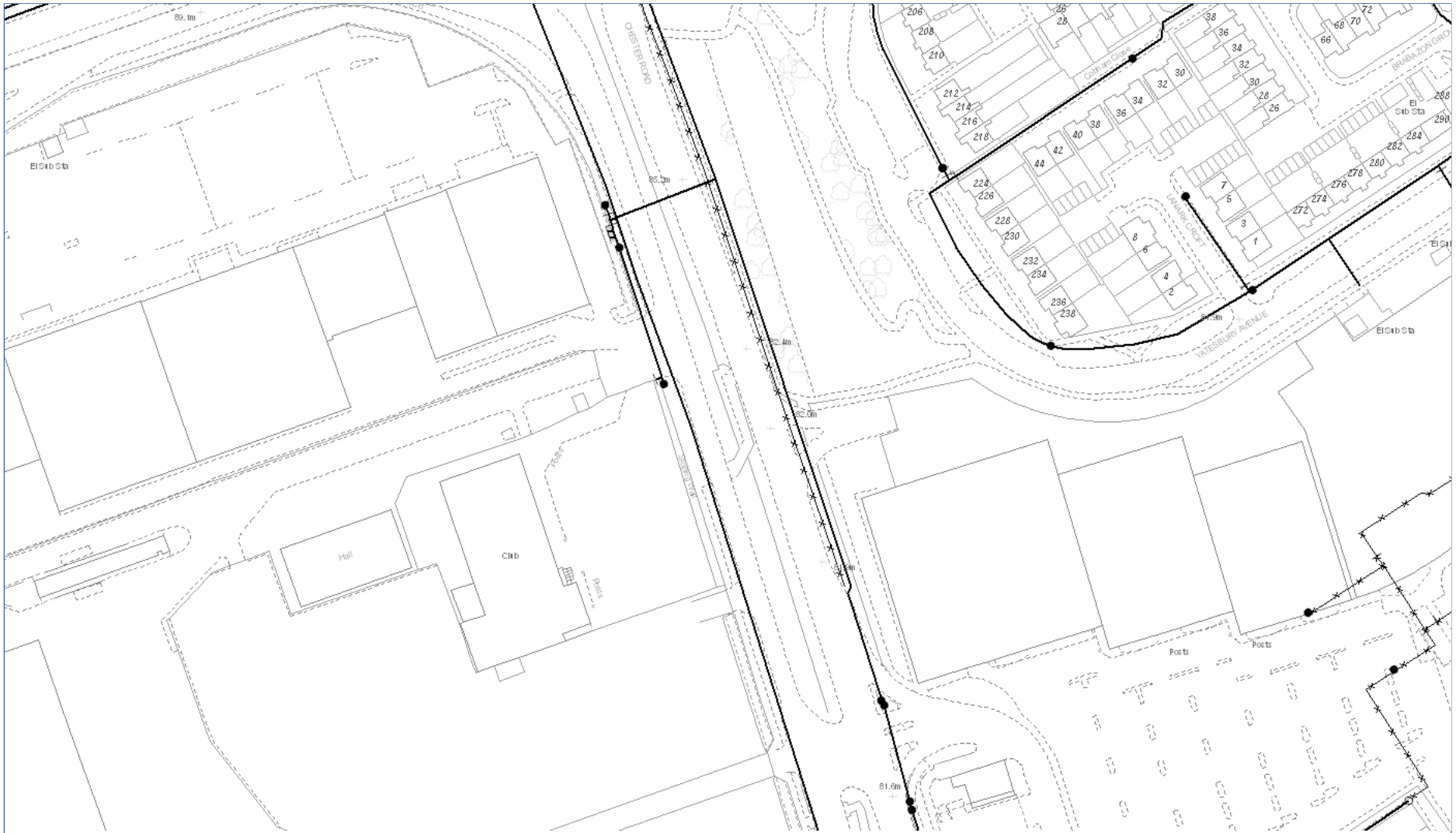

| | | |
|--------------------|-------------------|-----------------|
| Water main | Aqueduct | Abandoned pipe |
| Fire main | Water valve | Air valve |
| Fire hydrant | Washout hydrant | Bulk meter |
| Non-return valve | Anode | Discharge |
| High voltage cable | Low voltage cable | Instrumentation |
| Duct | | |



Water Mains Record

Severn Trent Water Limited
 Asset Data Management
 PO Box 5344
 Coventry
 CV3 9FT
 Telephone: 0845 601 6616

O/S Map scale: Approx. 1:1250

Date of Issue: 04 03 2011

Do not scale off this drawing

This map is centered upon OS Grid Ref:
 x - 413688.0 y - 291100.0

1. This plan and any information supplied with it is furnished as a general guide, is only valid at the date of issue and no warranty as to its correctness is given or implied. In particular this plan and any information shown on it must not be relied upon in the event of any development or works (including but not limited to excavations) in the vicinity of Severn Trent's assets or for the purposes of determining the suitability of a point of connection to the sewerage or distribution systems.
2. The material contained in this drawing has been based upon the Ordnance Survey Map by SEVERN TRENT WATER Ltd, by permission of Ordnance Survey on behalf of the controller of her Majesty's Stationary Office. © Crown Copyright & SEVERN TRENT WATER Ltd. & 100018202
3. Document users other than SEVERN TRENT WATER business users are advised that this document is provided for reference purpose only and no further copies should be made.

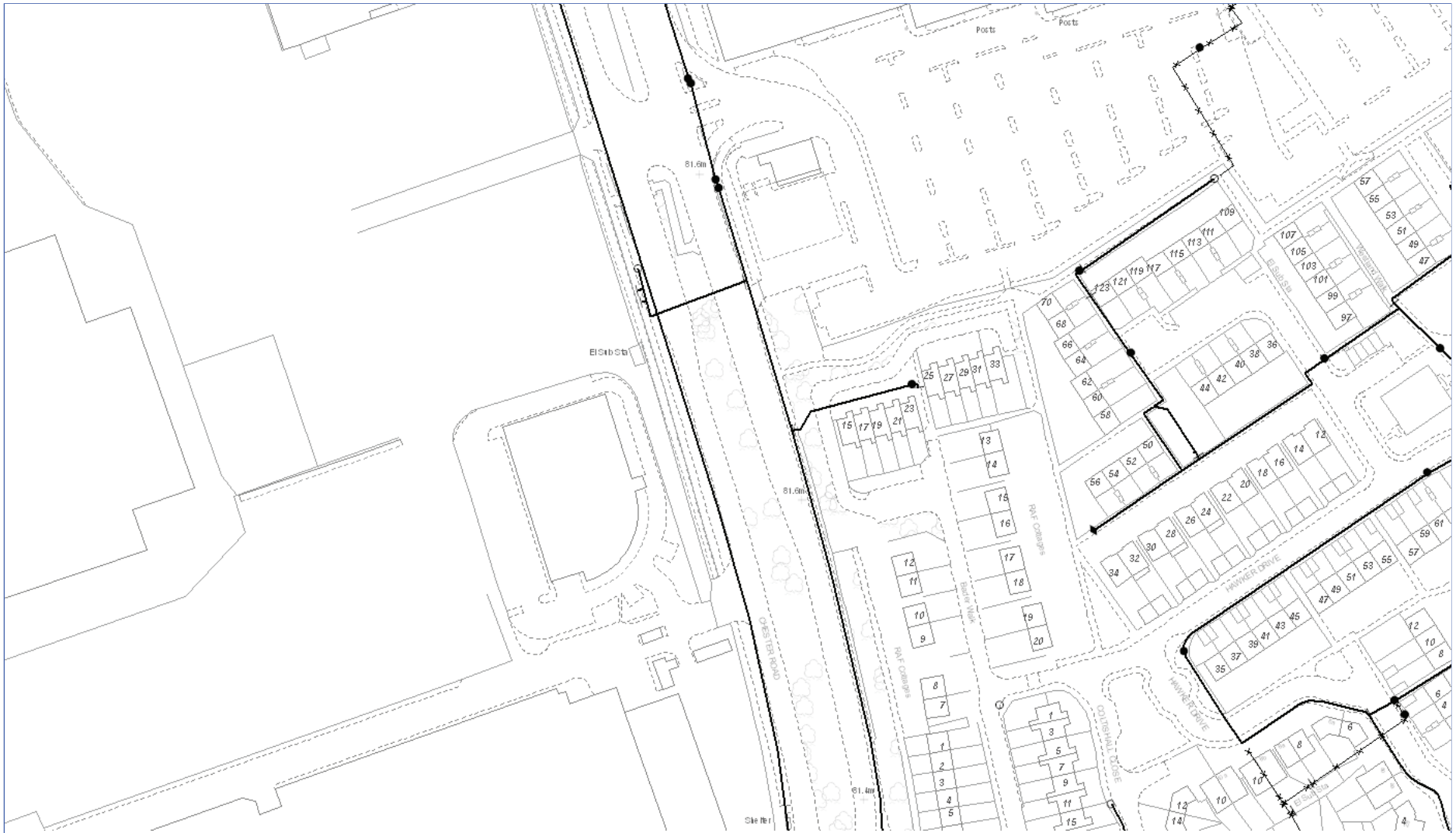

| | | |
|--------------------|-------------------|-----------------|
| Water main | Aqueduct | Abandoned pipe |
| Fire main | Water valve | Air valve |
| Fire hydrant | Washout hydrant | Bulk meter |
| Non-return valve | Anode | Discharge |
| High voltage cable | Low voltage cable | Instrumentation |
| Duct | | |



Severn Trent Water Limited
 Asset Data Management
 PO Box 5344
 Coventry
 CV3 9FT
 Telephone: 0845 601 6616

Water Mains Record

O/S Map scale: Approx. 1:1250

Date of Issue: 04 03 2011

Do not scale off this drawing

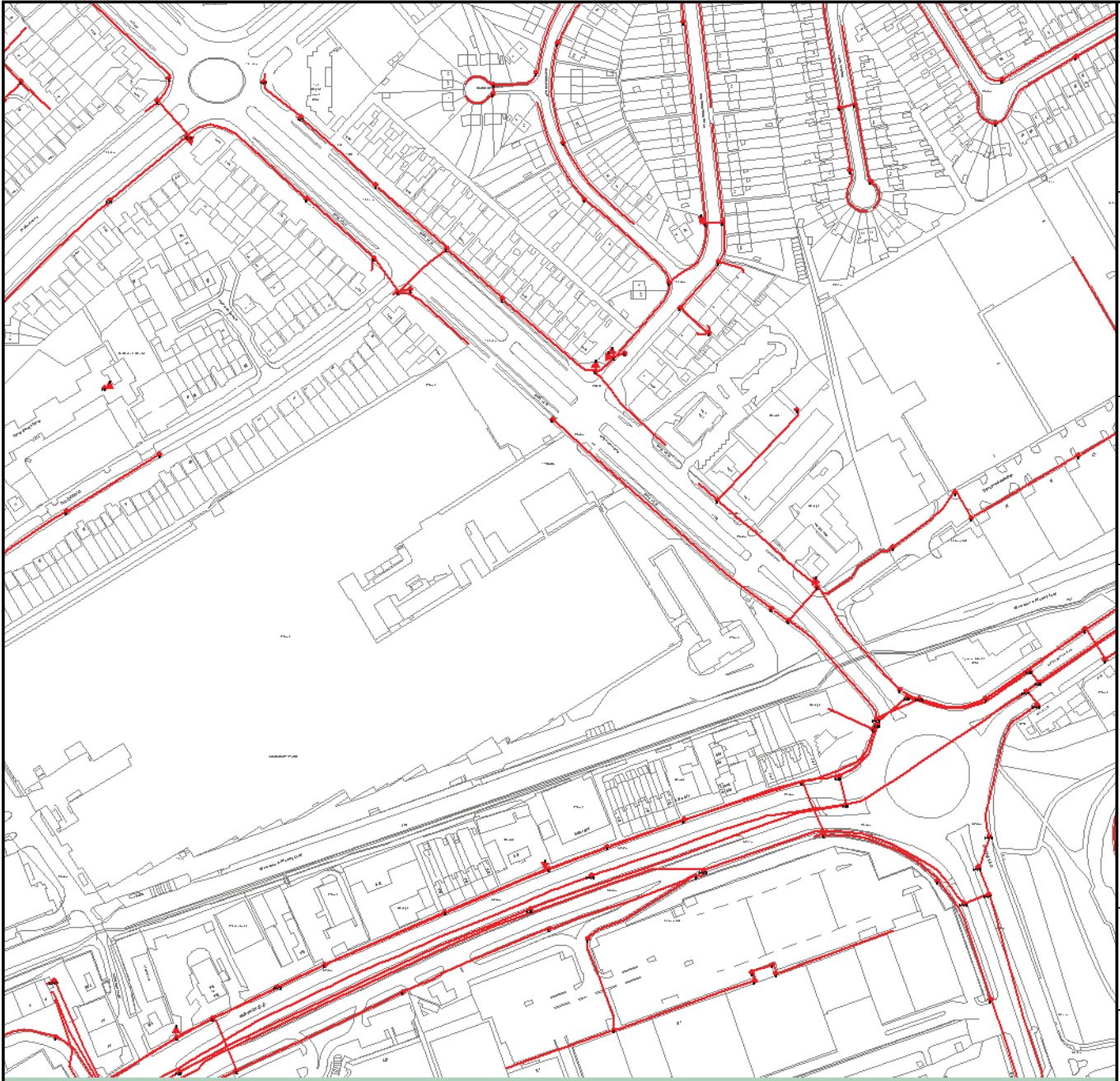

This map is centered upon OS Grid Ref:
 x - 413750.0 y - 290901.0

1. This plan and any information supplied with it is furnished as a general guide, is only valid at the date of issue and no warranty as to its correctness is given or implied. In particular this plan and any information shown on it must not be relied upon in the event of any development or works (including but not limited to excavations) in the vicinity of Severn Trent's assets or for the purposes of determining the suitability of a point of connection to the sewerage or distribution systems.
2. The material contained in this drawing has been based upon the Ordnance Survey Map by SEVERN TRENT WATER Ltd, by permission of Ordnance Survey on behalf of the controller of her Majesty's Stationery Office. © Crown Copyright & SEVERN TRENT WATER Ltd. &C 100018202
3. Document users other than SEVERN TRENT WATER business users are advised that this document is provided for reference purpose only and no further copies should be made.



Title:
A3 LANDSCAPE

Legend:

| | |
|--------------|---|
| Duct, Trench |  |
| Chamber |  |
| Cabinet |  |

Important Information - please read

The purpose of this plan is to identify Virgin Media apparatus. We have tried to make it as accurate as possible but we cannot warrant its accuracy. In addition, we caution that within Virgin Media apparatus there may be instances where mains voltage power cables have been placed inside green, rather than black ducting. Further details can be found using the 'Affected Postcodes.pdf', which can be downloaded from this website.

Therefore, you must not rely solely on this plan if you are carrying out any excavation or other works in the vicinity of Virgin Media apparatus. The actual position of any underground service must be verified by cable detection equipment, etc. and established on site before any mechanical plant is used. Accordingly, unless it is due to the negligence of Virgin Media, its employees or agents, Virgin Media will not have any liability for any omissions or inaccuracies in the plan or for any loss or damage caused or arising from the use of and/or any reliance on this plan.

This plan is produced by Virgin Media Limited from Ordnance Survey © Crown Copyright 100019209

Map Centre:
413401, 291399

Date:
04 Mar 2011

Scale:
1 :2500



Title:
A3 LANDSCAPE

Legend:

| | |
|--------------|---|
| Duct, Trench |  |
| Chamber |  |
| Cabinet |  |

Important Information - please read

The purpose of this plan is to identify Virgin Media apparatus. We have tried to make it as accurate as possible but we cannot warrant its accuracy. In addition, we caution that within Virgin Media apparatus there may be instances where mains voltage power cables have been placed inside green, rather than black ducting. Further details can be found using the 'Affected Postcodes.pdf', which can be downloaded from this website.

Therefore, you must not rely solely on this plan if you are carrying out any excavation or other works in the vicinity of Virgin Media apparatus. The actual position of any underground service must be verified by cable detection equipment, etc. and established on site before any mechanical plant is used. Accordingly, unless it is due to the negligence of Virgin Media, its employees or agents, Virgin Media will not have any liability for any omissions or inaccuracies in the plan or for any loss or damage caused or arising from the use of and/or any reliance on this plan.

This plan is produced by Virgin Media Limited from Ordnance Survey © Crown Copyright 100019209

Map Centre:
413792, 291243

| | |
|----------------------|-------------------|
| Date: 04 Mar 2011 | Scale: 1 :2500 |
|----------------------|-------------------|